

Copyright © 2016. The copyright and all other rights in this document are reserved by Jacobs Engineering Group Limited. This document is the property of Jacobs Engineering Group Limited and is not to be reproduced, stored in a retrieval system, or transmitted in any form or by any means, electronic, mechanical, photocopying, recording, or by any information storage and retrieval system, without the prior written permission of Jacobs Engineering Group Limited. This document is for the use of the client only and is not to be distributed to any other party. The use of this document for any other purpose is strictly prohibited. The design and construction of any project is the responsibility of the client and the contractor. Jacobs Engineering Group Limited is not responsible for any errors or omissions in this document. Some of the images used in this document have been sourced from the internet and are not necessarily the property of Jacobs Engineering Group Limited.

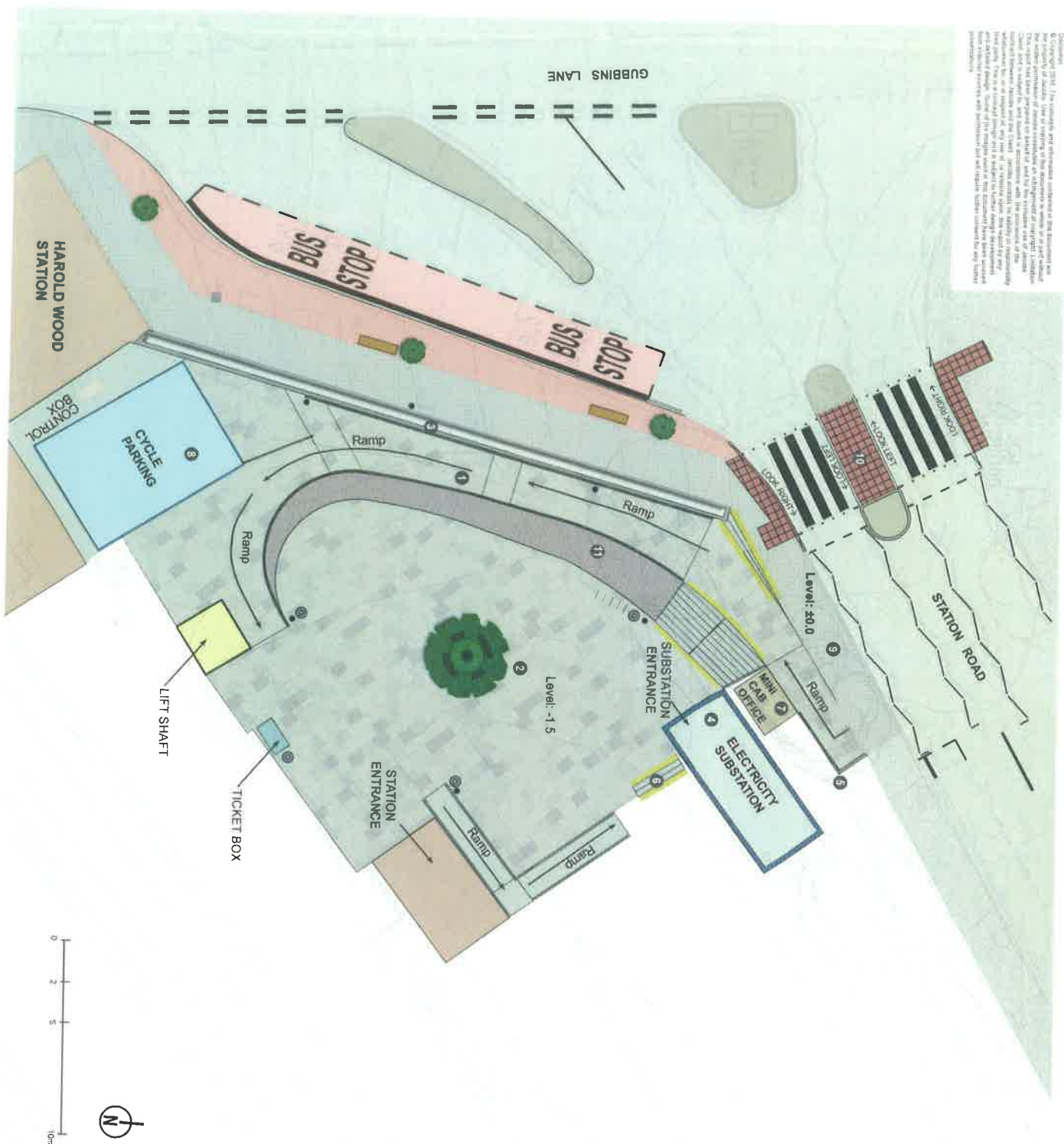

PLAZA DESIGN CONCEPT WITH A GRADUAL RAMP

DESIGN SUGGESTIONS

- 1 A gradual ramp encircling the plaza to create a seamless level transition and visual interest in the sunken plaza.
- 2 Central plaza area with feature tree, perch seating, ticketing facility and granite or concrete paving.
- 3 The existing retaining wall to be presented as a feature backdrop for the station plaza. The design features include:
 - The existing brick wall to the top of the retaining wall lowered by several courses to make the plaza more visually permeable from the bus stop area.
 - Retaining wall to be refreshed with a rendered finish.
 - Crossrail coloured feature band with stainless steel station name.
- 4 The substation interface to be clad with louvered metal cladding.
- 5 The existing advertising boards may need to be relocated and aesthetically improved to enhance the entrance.
- 6 Steps and ramp to car park.
- 7 The existing min-cab office to be relocated closer to the substation.
- 8 Cycle storage unit refurbished.
- 9 Legible London sign and totem.
- 10 The zebra crossing extended to accommodate the informal crossing that currently occurs outside the station exit.
- 11 Potential for a sloped ramp embankment to be made from permeable material.

LEGEND

	Plaza paving		Cycle stand
	Retaining wall		Benches
	Tactile Paving		Bin
	Modular concrete pavers		Light column
	Existing tegula blocks		Hazard paving for steps
	Proposed trees		

HAROLD WOOD STATION
CROSSRAIL COMPLEMENTARY MEASURES
CONSULTATION
DESIGN CONCEPT

PAGE 2 OF 5
SCALE 1:100 @ A1
FEBRUARY 2016
B3172000-04 Rev00

