

LICENSING SUB-COMMITTEE SUPPLEMENTARY AGENDA DARTS KNIGHT

2 October 2025

The following report is attached for consideration and is submitted with the agreement of the Chairman as an urgent matter pursuant to Section 100B (4) of the Local Government Act 1972

5 APPLICATION FOR A PREMISES LICENCE - DARTS KNIGHT (Pages 3 - 16)

The following supplementary documents have been provided by Darts Knight Ltd.

**Zena Smith
Head of Committee & Election
Services**

This page is intentionally left blank

Evidence 1a

Alcohol Sales Policy

Darts Knight Ltd
27 Station Lane, Hornchurch,
Essex, RM12 6JL

1. General Principles

- Alcohol sales are ancillary to the darts activities.
- The premises is not operated as a bar. Alcohol will be provided to **adults** to complement the leisure activity.
- Alcohol will be stored in fridges, positioned below the shop counter and not on general view. There will be no self service of alcohol.
- A selection of Beer and wine to be served only. There will be no spirits or high percentage alcohol available.
- The aim is to provide a safe, enjoyable environment for all ages while protecting children and the community.

2. Age verification

- A strict Challenge 25 policy will be enforced
- Accepted proof of age: passport, photocard driving licence, PASS-approved card.
- Staff are trained to refuse service if ID is not provided when required.
- Clear Challenge 25 signage will be displayed at point of sale.

3. Refusals & Incident log

- A refusals log will be maintained for all attempted underage or intoxicated sales.
- An incident log will be kept for any disorder, ejections or complaints.
- Both logs will be available to the Licensing Authority and Police upon request.

4. Intoxication Checks

- Alcohol will not be sold to anyone who appears drunk.
- Staff are trained to monitor behaviour and escalate concerns to Manager.
- Water and soft drinks will also be available

5. Staff Training

- All staff will receive induction and refresher training covering:
- Licensing Act responsibilities
- Challenge 25 procedures
- Recognising signs of intoxication
- Recording refusals and incidents
- Training records will be kept and updated regularly.

6. Closing & Dispersal Plan

- Alcohol service will stop 30 minutes before closing
- Clear 'respect our neighbours' signage at exit.

Signed :  Director

Date 22nd September 2025

1. General Principles

- The premises is a retail and leisure venue centred on darts merchandise sales and lane hire.
- The sale of alcohol is ancillary to the darts activities and is not the focus of the business.
- The safety and welfare of children on our premises is a priority.

2. Entry of Children

- Children under 16 are not permitted to play on a lane unless they are accompanied by a responsible adult (aged 18 or over)
- Children will be able to come into the retail section unaccompanied to purchase darts merchandise but under no circumstances will be sold alcohol.
- We intend to hold Youth tournaments, Youth academies and possible youth training. These events will be supervised at all times by responsible adults and alcohol sales suspended to the respective lanes and areas being used by the youths during this time.
- Staff will be trained to monitor compliance and may ask for proof of id if in any doubt.

3. Alcohol Restrictions

- Alcohol will only be sold to and consumed by persons 18 and over
- A challenge 25 policy will be strictly enforced with a clear sign placed on the counter area.

4. Staff Training and Monitoring

All staff will receive training in:

- Age verification (Challenge 25)
- Dealing with underage attempts to purchase alcohol
- A refusal log will be kept and made available to the licensing authority upon request.

Signed :  Director

Dated: 22nd September 2025

[illegible]

Incident Log

[illegible]

Staff Training Log					
Premises Name: Premises Address:	Job Title	Training Topics covered (tick all that apply)	Date of Training	Staff Signature	Manager Verification
Darts Knight Ltd 27 Station Lane, Hornchurch, Essex, RM12 1LP					
		<input type="checkbox"/> Challenge 25 <input type="checkbox"/> Refusal Log <input type="checkbox"/> Incident Log <input type="checkbox"/> Intoxication Awareness <input type="checkbox"/> Other:			
		<input type="checkbox"/> Challenge 25 <input type="checkbox"/> Refusal Log <input type="checkbox"/> Incident Log <input type="checkbox"/> Intoxication Awareness <input type="checkbox"/> Other:			
		<input type="checkbox"/> Challenge 25 <input type="checkbox"/> Refusal Log <input type="checkbox"/> Incident Log <input type="checkbox"/> Intoxication Awareness <input type="checkbox"/> Other:			
		<input type="checkbox"/> Challenge 25 <input type="checkbox"/> Refusal Log <input type="checkbox"/> Incident Log <input type="checkbox"/> Intoxication Awareness <input type="checkbox"/> Other:			
		<input type="checkbox"/> Challenge 25 <input type="checkbox"/> Refusal Log <input type="checkbox"/> Incident Log <input type="checkbox"/> Intoxication Awareness <input type="checkbox"/> Other:			
		<input type="checkbox"/> Challenge 25 <input type="checkbox"/> Refusal Log <input type="checkbox"/> Incident Log <input type="checkbox"/> Intoxication Awareness <input type="checkbox"/> Other:			
		<input type="checkbox"/> Challenge 25 <input type="checkbox"/> Refusal Log <input type="checkbox"/> Incident Log <input type="checkbox"/> Intoxication Awareness <input type="checkbox"/> Other:			
		<input type="checkbox"/> Challenge 25 <input type="checkbox"/> Refusal Log <input type="checkbox"/> Incident Log <input type="checkbox"/> Intoxication Awareness <input type="checkbox"/> Other:			
		<input type="checkbox"/> Challenge 25 <input type="checkbox"/> Refusal Log <input type="checkbox"/> Incident Log <input type="checkbox"/> Intoxication Awareness <input type="checkbox"/> Other:			
		<input type="checkbox"/> Challenge 25 <input type="checkbox"/> Refusal Log <input type="checkbox"/> Incident Log <input type="checkbox"/> Intoxication Awareness <input type="checkbox"/> Other:			
		<input type="checkbox"/> Challenge 25 <input type="checkbox"/> Refusal Log <input type="checkbox"/> Incident Log <input type="checkbox"/> Intoxication Awareness <input type="checkbox"/> Other:			
		<input type="checkbox"/> Challenge 25 <input type="checkbox"/> Refusal Log <input type="checkbox"/> Incident Log <input type="checkbox"/> Intoxication Awareness <input type="checkbox"/> Other:			
		<input type="checkbox"/> Challenge 25 <input type="checkbox"/> Refusal Log <input type="checkbox"/> Incident Log <input type="checkbox"/> Intoxication Awareness <input type="checkbox"/> Other:			
		<input type="checkbox"/> Challenge 25 <input type="checkbox"/> Refusal Log <input type="checkbox"/> Incident Log <input type="checkbox"/> Intoxication Awareness <input type="checkbox"/> Other:			
		<input type="checkbox"/> Challenge 25 <input type="checkbox"/> Refusal Log <input type="checkbox"/> Incident Log <input type="checkbox"/> Intoxication Awareness <input type="checkbox"/> Other:			

This page is intentionally left blank

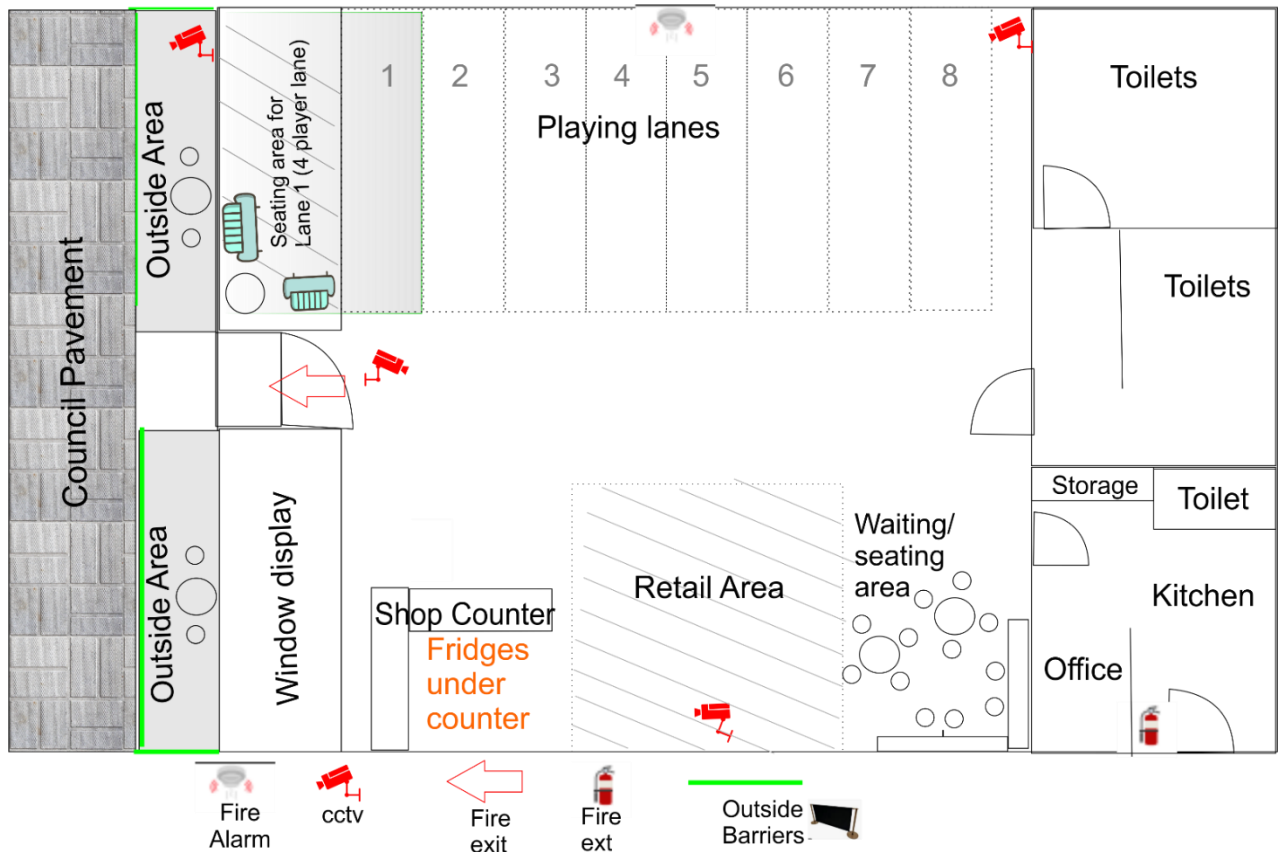

There are 8 playing lanes. Lane 1 is a strictly maximum of 4 players and has it's own seating area. Lanes 2-8 will be strictly maximum 2 players per lane. There is an additional seating area where adults accompanying children and people waiting for lane changeover can sit and wait.

Maximum occupancy inside shall not exceed 45 people.

We would like to have 2 small tables and 4 chairs with barriers outside similar to Frankie's Bar and other establishments in close proximity. There will be no music played outside. We would prefer that should people go outside to smoke/take phone calls they stay within the barriers rather than wandering up and down the street.

This page is intentionally left blank

Darts Knight Ltd
RM12 6JL

27 Station Lane, Hornchurch

2nd October 2025

1. Acknowledgement of the CIZ

We recognise that the premises is located within a designated Cumulative Impact Zone. We fully understand the concerns behind this policy — namely, preventing crime, disorder, and public nuisance caused by an over-concentration of licensed premises

2. Distinct Nature of the Business

- The premises is **not a bar, nightclub, or late-night venue**.
- Alcohol sales are **ancillary** to the core business: darts equipment retail and supervised lane hire.
- Customers are engaged in **structured activities**, not vertical drinking or pub-crawling.
- Lanes are booked by the hour and therefore there will be no ‘all day’ or prolonged drinking sessions within our premises. The following shows an example of bookings made for Saturday 27th September. Nobody has booked in excess of 1 hour:

Saturday 27th September				Online Bookings				Opening time 10.00-19.00	
Time	Lane 1 4 player Scolia	Lane 2	Lane 3	Lane 4	Lane 5 2 player Omni	Lane 6	Lane 7	Lane 8	
10.00-11.00		Jay M							
11.00-12.00					Luke W				
12.00-13.00			Sarah M						
13.00-14.00	Nicola W	Nicola W				Bobby K			
14.00-15.00	Paul S						Max M		
15.00-16.00					Vanessa C				
16.00-17.00									
17.00-18.00	Rav A	Chantelle E							
18.00-19.00	Jamie M				Bobby T		Jack O'D	Michaela M	

3. Reduced Risk Profile

- **Family-friendly environment:** children permitted only with responsible adults, and alcohol restricted to adults.
- **Limited and controlled alcohol offer:** no high-strength cheap drinks, no walk-in alcohol sales, no “drinking-only” customers.
- **Hours:** Alcohol service ends before closing to ensure calm dispersal.

4. Safeguards in Place

We have adopted comprehensive written policies covering:

- Child Access
- Alcohol Sales
- Public Safety
- Customer Dispersal & Neighbour Safety

These measures directly support the four licensing objectives and reduce the likelihood of any negative cumulative impact.

5. Conclusion

Given the nature of the business, the customer base, and the proactive policies in place, we respectfully submit that granting this application will **not add to the existing cumulative impact** in the area. Instead, it will provide a well-managed, family-oriented leisure venue that complements — rather than competes with — the bars and night-time economy premises around it.

Signed: 

Director

Date: 22nd September 2025

Evidence 4a

Open Letter Results

We have received **419** signatures in response to our open letter (see files attached as Evidence numbered 4c & 4d)

You can see the highlighted Hornchurch residents with RM12 & RM11 postcodes and they total **206** which equates to just over 49% of the total signatures, with a further **119** signatures from neighbouring RM postcodes and **94** from outside of the RM postcodes.

Signed..........

Director

Date22/09/2025.....



Darts Knight Ltd
27 Station Lane
Hornchurch
Essex
RM12 6JL

To the London Borough of Havering Licensing Committee,

We, the undersigned members of the Hornchurch community, wish to express our support for the application by Darts Knight, located at 27 Station Lane, Hornchurch, Rm12 6JL, to be granted a licence to sell alcohol.

Darts Knight is primarily a darts merchandise shop and recreation venue. With eight professional playing lanes, its focus is firmly on the enjoyment of darts – offering individuals, families, and groups a safe and welcoming place to play.

The alcohol licence is sought not to create a pub type bar, but simply to allow customers to enjoy refreshments while they play. The management team have committed to running the premises responsibly, including staff training, Challenge 25, and clear policies to prevent nuisance or disturbance.

We believe Darts Knight will bring a range of benefits to Hornchurch, including:

- A unique community hub centred around sport and recreation.
- A safe, family-friendly environment that encourages social connection.
- Employment opportunities for local people.
- A positive contribution to the local economy and town centre.

For these reasons, we strongly support this licence being granted.

Please find attached a list of signatures in support of our Application to sell alcohol

Signed DKnight

Director

Date22/09/2025.....

The emphasis of our business plan is on retail and playing darts in slots of 1 hour bookings. In general people will hire a lane for 1 or maybe 2 hours. Therefore their alcohol consumption in our premises is likely be limited to that time, focussing on play rather than drinking. There are numerous licenced establishments they can go to if their sole intention is drinking and partying.

Staff will be trained into recognising drunken behaviour and will emit them from the premises should they show signs of disruptive behaviour through excess drinking. CCTV recordings will be kept for 31 days and made available to local authorities and police.

A sign will be placed on the door to encourage customers to respect local neighbours by leaving quietly.

Music will only be played as background music

The following map shows the licensed premises within the immediate area

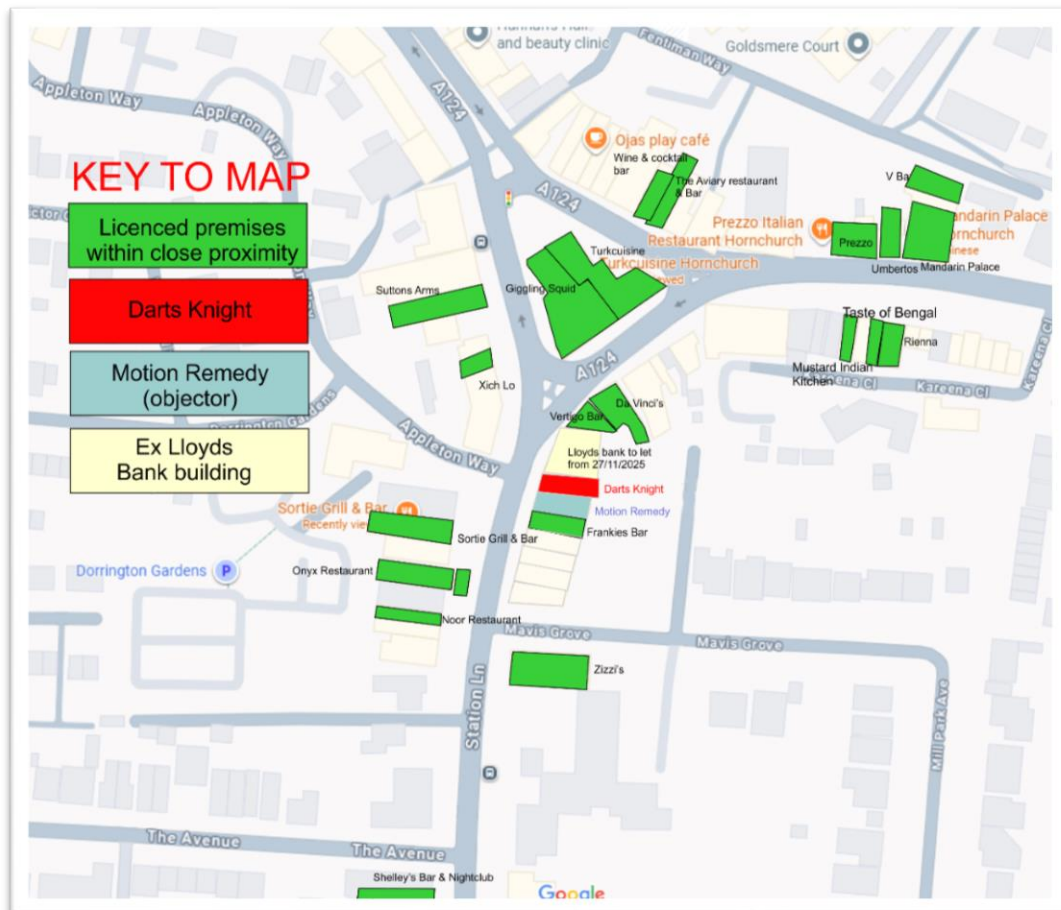

We are surrounded by licensed premises (shown in green within 150m of us) Also, due to it's large square footage and the current trend of High Streets, the Lloyds Bank building which is now empty and available to Let in November this year, is highly likely to gain interest from restaurants, clubs, bars etc requiring a license. If they were to be successful in their application and I am not, I would consider this very unfair.

I strongly feel that with the steps and policies I have put in place, I am confident that our premises will not bring any additional noise or disturbance to the area.

This page is intentionally left blank