



Haverling

LONDON BOROUGH

LICENSING SUB-COMMITTEE (Park Lane Food Centre) AGENDA

10.30 am	Monday 4 April 2011	Haverling Town Hall Main Road, Romford
-----------------	--------------------------------	---

Members 3: Quorum: 2

COUNCILLORS:

Conservative Group (2)

Residents' Group (1)

Peter Gardner(Chairman)
Melvin Wallace

Linda Van den Hende

For information about the meeting please contact:

Andrew Beesley (01708) 432437

e-mail: andrew.beesley@haverling.gov.uk

AGENDA ITEMS

1 **APOLOGIES FOR ABSENCE AND ANNOUNCEMENT OF SUBSTITUTE MEMBERS**
(if any) - receive.

2 **DECLARATION OF INTERESTS**

Members are invited to declare any interests in any of the items on the agenda at this point of the meeting. Members may still declare an interest in an item at any time prior to the consideration of the matter.

3 **CHAIRMAN'S ANNOUNCEMENTS**

The Chairman will announce details of the arrangements in case of fire or other events that might require the meeting room or building's evacuation.

APPLICATION TO VARY A PREMISES LICENCE – Park Lane Food Centre, 77 Park Lane, Hornchurch, RM11 1BH - documentation attached

4 **REPORT OF CLERK**

5 **REPORT OF LICENSING OFFICER**

**Philip Heady
Democratic Services Manager**



LICENSING SUB-COMMITTEE

REPORT

4 April 2011

Subject Heading:

Procedure for the Hearing: Licensing Act 2003

Report Author and contact details:

Andrew Beesley (01708) 432437
e-mail: andrew.beesley@havering.gov.uk

Members are advised that, when considering an application to vary a premises licence, the following options are available to them by virtue of the Licensing Act 2003, Part 3, section 35, paragraphs 3 and 4:

"Where relevant representations are made, the authority must

- (a) hold a hearing to consider them, unless the authority, the applicant and each person who has made such representations agree that a hearing is unnecessary, and
- (b) having regard to the representations, take such steps as it considers necessary for the promotion of the licensing objectives.

The steps are:

- a) modify the conditions of the licence
- b) reject the whole or part of the application

and for this purpose, the conditions of the licence are modified if any of them is altered or omitted or any new condition is added."

The Sub-Committee will also wish to note that, if none of these steps is required, the application must be granted.

Assuming that the Sub-Committee is satisfied that a hearing is required, then the following procedural steps are recommended. The Licensing Act 2003 (Hearings) Regulations 2005 will govern the arrangements for the hearing of the application now under consideration. This report accords with the requirements of that Act and the Regulations, and in particular Regulations 21-25 (procedure at the hearing).

1. Membership of the Sub-Committee:

- 1.1 The Sub-Committee comprises three members of the Licensing Committee, with a quorum of two members. **Unless there are objections, in the absence of three members, the hearing shall proceed with the quorum of two.**
- 1.2 A members of the Licensing Committee will be excluded from hearing an application where he or she:
 - 1.2.1 has considered an application in respect of the premises in the previous 12 months as a Member of the Regulatory Services Committee; or
 - 1.2.2 is a Ward Councillor for the Ward in which the premises, subject to the application, are located; or
 - 1.2.3 is a Ward Councillor for a Ward which is likely to be affected by the application or;
 - 1.2.4 has a personal interest in the application.

2. Roles of other participants:

- 2.1 The Legal Advisor is not a party to the hearing. The role of the Legal Advisor is to provide legal advice relating to the application and submissions.
- 2.2 The Clerk is not a party to the hearing. The role of the Clerk is to record the hearing and the decisions of the Sub-Committee, and ensure efficient administration

3. Representation validation meeting:

- 3.1 Prior to this hearing, the Sub-Committee Chairman will have met the Legal Advisor and/or Clerk to determine whether further clarification is required of any issues contained in the application or any representation.
- 3.2 During this preliminary meeting no decision will have been made or discussion held regarding the substantive merits of the application or representations.

4. Location and facilities:

- 4.1 All hearings will be heard at the Havering Town Hall unless otherwise directed.
- 4.2 Interpreters will be provided by the Council on request, provided notice is given at least five working days before the hearing.

5. Notification of attendance:

- 5.1 The Chairman will enquire of the parties who is in attendance and the parties will indicate their names (and, where relevant, whom they represent). A register will be circulated before the commencement of the hearing on which the applicant, his/her advisers and companions and all interested parties (and/or their representatives) will be asked to record their attendance.

6. Procedural matters:

- 6.1 Prior to the commencement of the hearing, the Chairman of the Sub-Committee will orally inform the parties whether their applications to have certain people attend the hearing (e.g. witnesses) have been granted or refused. Note this relates to people other than those attending on behalf of a party in the capacity as a representative of the party.
- 6.2 Prior to the commencement of the hearing the Chairman of the Sub-Committee will outline the procedure to be followed at the hearing. This will normally be as follows:

Introduction of the application:

The Licensing officer will outline:

- details of the application and relevant representations received from the parties;
- relevant legislation ;
- relevant Licensing Policy; and
- the time limit in which the Council must reach a determination.

Documentary evidence:

- Documentary or other information in support of applications, representations or notices should be provided to the Clerk of the Sub-Committee at least 7 clear working days before the hearing. If this information is produced at the hearing it will only be taken into account by the Sub-Committee if the Sub-Committee and all the parties consent to its submission. Permission to have this information included in the hearing should be requested at the beginning of the hearing before any oral submissions have been made.
- Statements made by people in support of a party's representation who are not present at the hearing, must be signed by the maker, dated and witnessed by another person. The statement must also contain the witness's full name and occupation.

Representations:

- The chairman will invite each of the parties at the hearing or their representative sequentially to address the Sub-Committee and call any person/s to whom permission has been granted to appear. Each party will be allowed a maximum period of 10 minutes in which to address the Sub-Committee and call persons on his/her behalf.
- This 10 minute period is where each party has the opportunity to orally address the Sub-Committee and clarify any points in which the Sub-Committee has sought clarification prior to the hearing. This 10 minute period should be uninterrupted unless a member of the Sub-Committee or Legal Advisor considers that the speaker is making submissions that are irrelevant, frivolous or vexatious.
- Members of the Sub-Committee may ask questions of any party, at any time during the proceedings. Time taken in dealing with a Member's question will not be taken into account in determining the length of time available to the party in question to make their representation.

The sequence in which each of the parties will be invited to address the Sub-Committee will normally be in the order of:

- the Chief Officer of Police;
- the Fire Authority;
- the Health and Safety at Work Enforcing Authority;
- the Local Planning Authority;
- the Local environmental Health Authority;
- the Local Weights and Measures Authority;
- the Authority Responsible for the Protection of Children from Harm;
- a navigation or other authority responsible for waterways; and
- any other party that has submitted representations in respect of the application, certificate, notice or other matter appearing before the Sub-Committee;
- the party that has submitted the application, certificate, notice or other matter appearing before the Sub-Committee.

At the discretion of the Sub-Committee the above order may be varied.

Cross-Examination:

Where witnesses have been permitted by the Sub-Committee to speak at the hearing on behalf of a party, permission must be sought from the Sub-Committee before another party can ask the witness questions. This process of questioning is normally referred to as cross-examination. The Sub-Committee will allow cross-examination only where it is necessary to assist it in considering the representations or application.

Relevance:

Information submitted at the hearing must be relevant to the applications, representations, or notice and the promotion of the licensing objectives. The Chairman of the Sub-Committee is entitled to exclude any information it considers to be irrelevant whether presented in written or oral form. The licensing objectives are:

- The prevention of crime and disorder;**
- Public safety;**
- The prevention of public nuisance; and**
- The protection of children from harm.**

7. Failure of parties to attend the hearing:

- 7.1 If a party, who has not given prior notice of his/her intention not to attend the hearing, is absent from the hearing the Sub-Committee may either adjourn the hearing or hold the hearing in the party's absence. Where the hearing is held in the absence of a party, the Sub-Committee will still consider the application, representation or notice submitted by that party.

8. Adjournments and extension of time:

- 8.1 The Sub-Committee may adjourn a hearing to a specified date or extend a notice period except where it must make a determination within certain time limits in the following specific applications:

- Applications for conversion of existing licences where the Sub-Committee must make a determination within 2 months of the application first being received. In default of a decision being made the application will be treated as being granted;
- Applications for variation of existing licences where the Sub-Committee must make a determination within 2 months of the application first being received. In default of a decision being made the application will be treated as being rejected;
- Applications for conversion of existing club certificates where the Sub-Committee must make a determination within 2 months of the application being first received. In default of a decision being made the application will be treated as being granted;
- Applications for variation of existing club certificates where the Sub-Committee must make a determination within 2 months of the application being first received. In default of a decision being made the application will be treated as being rejected;
- Applications made by holders of justices' licences for personal licences must be determined within 3 months of the application first being

received. In default of a decision not being made within this period the application will be treated as being granted;

- Review of premises licences following closure orders where the Sub-committee must make a determination within 28 days of receiving notice of the closure order.

9. Sub-Committee's determination of the hearing:

- 9.1 At the conclusion of the hearing the Sub-Committee will deliberate in private accompanied by the Clerk and the Legal Advisor who will be available to assist the Sub-Committee with any legal problems but will not participate in any decision making of the Sub-Committee.
- 9.2 The Sub-Committee will normally make its determination and announce its decision at the end of the hearing.
- 9.3 Where all parties have notified the Sub-Committee that a hearing is not required the Sub-Committee must make its determination within 10 working days of being given notice that the hearing is not required.

10. Power to exclude people from hearing:

- 10.1 The public are entitled to attend the hearing as spectators. However, the Sub-Committee may exclude any person from the hearing including any person assisting or representing a party where:
- it considers that the public interest would be best served by excluding the public or the individual person from the hearing; or
 - that person is behaving in a disruptive manner. This may include a party who is seeking to be heard at the hearing. In the case where a party is to be excluded, the party may submit to the Sub-Committee in writing any information which they would have been entitled to give orally had they not been required to leave the hearing.

11. Recording of proceedings:

- 11.1 A written record of the hearing will be produced and kept for 6 years from the date of the determination of the hearing.

12. Power to vary procedure:

- 12.1 The Sub-committee may depart from following any of the procedures set out in this document if it considers the departure to be necessary in order to consider an application, notice or representation.

Licensing Committee Hearing

**Park Lane Food Centre,
77 Park Lane,
Hornchurch
RM11 1BH**

Contents

Licensing Officers report

Map of the area

Current premises licence

Application

Interested parties representations

Responsible authority representations

Representations supporting the application

Licensing Officers report



LICENSING SUB-COMMITTEE

REPORT

Date: 4 April 2011

Subject Heading:

Park Lane Food Centre
77 Park Lane
Hornchurch
RM11 1BH

Report Author and contact details:

Steve Bromley, Licensing Officer
5th floor Mercury House
01708 433816

This application for a variation to a premises licence is made by Mrs Hatice Sapkur under Section 34 of the Licensing Act 2003. The application was received by Havering's Licensing Authority on the 11th February 2011.

Geographical description of the area

The premises are situated in a row of business premises in Park Lane. The area has a high residential occupancy. Park Lane is a busy road that is restricted by the presence of numerous parked vehicles on a regular basis. Please see attached map.

Details of the application

The applicant is applying to vary the existing Premises Licence for the supply of alcohol and the opening hours of the premises.

Current Premises Licence

Supply of Alcohol		
Day	Start	Finish
Monday to Sunday	08:00hrs	20:00hrs

Opening Hours		
Day	Start	Finish
Monday to Sunday	08:00hrs	23:00hrs

Application

Supply of Alcohol		
Day	Start	Finish
Sunday to Thursday	08:00hrs	23:00hrs
Friday and Saturday	08:00hrs	00:00hrs

Opening Hours		
Day	Start	Finish
Sunday to Thursday	07:00hrs	23:00hrs
Friday and Saturday	07:00hrs	00:00hrs

Comments and observations on the application

On the Wednesday the 8th of December 2010 I issued a formal warning letter to Mrs Hatice Sapkur and Mr Fazil Tubay after Mr Hasan Tubay sold alcohol to a council officer at the premises at approximately 21:10 hours.

On Friday the 11th of March 2011 Mr Fazil Tubay sold alcohol to a council officer at 20:30hrs. A second formal warning letter has been sent to Mrs Hatice Sapkur and Mr Fazil Tubay.

On both occasions the alcohol was clearly on display in the premises.

The applicant acted in accordance with regulations 25 and 26 of *The Licensing Act 2003 (Premises licences and club premises certificates) Regulations 2005* relating to the advertising of the application. The required public notice was installed in the Yellow Advertiser on the 16th February 2011.

Interested parties' representations

Forty-two (42) representations against the application have been received.

Responsible authority representations

A representation from PC Leonard the Metropolitan Police Licensing Officer has also been received.

Representations supporting the application

Twenty-nine (29) representations have also been received supporting the application.

Steve Bromley
Licensing Officer

YellowClassified

www.yellowadvertiser-today.co.uk

Selling something? BARGAIN ADS UNDER £100

Call 0905 624 0595

BARGAIN ADS OVER £100

Call 01268 503 400

Minimum charge £9.00 • 9.00am-5.00pm

Public Notices

LICENSING ACT 2003
NOTICE IS HEREBY GIVEN that Ms. Helen Sopley has applied to the Licensing Authority for a premises licence for the premises situated at the site of the premises known as Park Lane Food Centre, 717 Park Lane, Haverhill, Essex RM11 1BH as follows: To permit the sale of alcohol for consumption on the premises between 08.00 to 23.00 hours on Thursday and 08.00 to 00.00 hours on Friday & Saturday.
The premises for the purposes of the Licensing Act 2003 are situated at the site of the premises known as Park Lane Food Centre, 717 Park Lane, Haverhill, Essex RM11 1BH as follows: To permit the sale of alcohol for consumption on the premises between 08.00 to 23.00 hours on Thursday and 08.00 to 00.00 hours on Friday & Saturday.
It is an offence under section 158 of the Licensing Act 2003 to knowingly or recklessly make a false statement in connection with an application for a licence under the Licensing Act 2003.
G & T Licensing Consultants Tel: 07810 333 776
www.gandtlicensing.com

LICENSING ACT 2003
NOTICE IS HEREBY GIVEN that Ms. Helen Sopley has applied to the Licensing Authority for a premises licence for the premises situated at the site of the premises known as Park Lane Food Centre, 717 Park Lane, Haverhill, Essex RM11 1BH as follows: To permit the sale of alcohol for consumption on the premises between 08.00 to 23.00 hours on Thursday and 08.00 to 00.00 hours on Friday & Saturday.
The premises for the purposes of the Licensing Act 2003 are situated at the site of the premises known as Park Lane Food Centre, 717 Park Lane, Haverhill, Essex RM11 1BH as follows: To permit the sale of alcohol for consumption on the premises between 08.00 to 23.00 hours on Thursday and 08.00 to 00.00 hours on Friday & Saturday.
It is an offence under section 158 of the Licensing Act 2003 to knowingly or recklessly make a false statement in connection with an application for a licence under the Licensing Act 2003.
G & T Licensing Consultants Tel: 07810 333 776
www.gandtlicensing.com

LICENSING ACT 2003
NOTICE IS HEREBY GIVEN that Ms. Helen Sopley has applied to the Licensing Authority for a premises licence for the premises situated at the site of the premises known as Park Lane Food Centre, 717 Park Lane, Haverhill, Essex RM11 1BH as follows: To permit the sale of alcohol for consumption on the premises between 08.00 to 23.00 hours on Thursday and 08.00 to 00.00 hours on Friday & Saturday.
The premises for the purposes of the Licensing Act 2003 are situated at the site of the premises known as Park Lane Food Centre, 717 Park Lane, Haverhill, Essex RM11 1BH as follows: To permit the sale of alcohol for consumption on the premises between 08.00 to 23.00 hours on Thursday and 08.00 to 00.00 hours on Friday & Saturday.
It is an offence under section 158 of the Licensing Act 2003 to knowingly or recklessly make a false statement in connection with an application for a licence under the Licensing Act 2003.
G & T Licensing Consultants Tel: 07810 333 776
www.gandtlicensing.com

By phone

Recruitment: **01268 503 420**
Classified: **01268 503 430**
Monday-Thursday 9.00-5.30
Fri day 9.00-5.00
Calls may be monitored

By post

Yellow Advertiser
Acorn House
Great Oaks, Basildon,
Essex SS14 1AH

By fax

01268 503 418
01268 503 419
01268 503 455

In person

Pop into our town centre office
Monday-Thursday 9.00-5.30
Friday 9.00-5.00
Acorn House, Great Oaks
Basildon

Deaths

MICHAEL (MICK) WALSH
9th February 1926 - 6th February 2011
Michael Walsh of Chelmsford Avenue, Collier Row, Essex, died peacefully with family, aged 84, on 6th February 2011.
Much loved father, grandfather, and husband of May. Highly respected member of the Corpus Christi Church Parish and local community.
Funeral will take place at 1pm on Thursday 17th February at St. Philip's Church, Collier Row, Basildon (subject to change) (burial at the church from 1pm onwards).
All friends welcome. Flowers welcome or donations to the Corpus Christi Church.

Bargain Buys

SONY 30" LABRE TV (NOT LOD) very good condition £25
Tel: 07867 74675 Borekoff
PINE TABLE FOUR CHAIRS.
SR 3in x 21 7in 525 Tel: 01709 852750
SIX CURTAINS PLUS
TEBACKS, two single divet 525, pretty lay lattice pattern. 1230no. tel: 01975 571757.
COMPUTER, PAST PENTIUM
4, flat screen, keyboard, mouse, software loaded (ideal office), £50 Tel: 01285 768649
JANE POWERS TRIN BOULE
BUCCY, 3 swabster fabric bed included. Excellent condition, £420 new will accept £39.95
07850 905883
HOSTESS TROLLEY Philips, four serving dishes, excellent condition, 72cm wide x 68cm deep, £700 Tel: 01268 473366

NEW CLARIS BLACK GIRLS SHOES size 5-12, Claret, black, £100 Tel: 01268 473366
BAGS 9-12M BOYS CLOTHES very good condition, Next, M+S £100 Tel: 01268 473366

Articles Wanted

FOOTBALL PROGRAMMES WANTED
Cash paid for any pre 1970 League collectors (200+), including international programmes.
Tel: 01702 831573
STROOL, COVET. 1500no. Tel: 01268 503183
LADIES CLOTHES. size 10-12, very good condition, 10 items for £40.00. Tel: 01268 503183
VECTA MOUNTAIN BIKE. 28in wheels, 15 speed, quick releasing, nearly new, £50. Tel: 01268 797955.
LARGE MAHOAGANY GLASS 12" x 18" x 12" heavy, very good condition, buyer collects. £70. Tel: 07823 212159.

Articles for Sale

Beautiful First Holy Communion Vells with attached head-dresses, Choice of 7 between £20 and £25 each 01708 737325
MATSUI PORTABLE REMOTE TV and VIDEO RECORDER. hardly used, with wall bracket included. £40. Tel: 01268 473366
SMALL BOYS MOUNTAIN BIKE. 28in wheels, 15 speed, 18in gears, full 9-10yr old, excellent condition, £35. Tel: 01268 797955
SOLID OAK WALL UNIT. 6ft x 2ft 6in deep, excellent condition, £80. Tel: 01268 473366
SOLID OAK TV CABINET. excellent condition, £40. Tel: 01268 473366
NEW LEATHER FRANK BACCE SUIT. Blue & white. Sized for 38' chest. World suit person 5'4" to 5'8". Good condition. £100. Tel: 01268 473366

Business Advertising

Articles for Sale

Beautiful First Holy Communion Vells with attached head-dresses, Choice of 7 between £20 and £25 each 01708 737325

Articles Wanted

FOOTBALL PROGRAMMES WANTED
Cash paid for any pre 1970 League collectors (200+), including international programmes.
Tel: 01702 831573

Articles for Sale

Beautiful First Holy Communion Vells with attached head-dresses, Choice of 7 between £20 and £25 each 01708 737325

Articles for Sale

Beautiful First Holy Communion Vells with attached head-dresses, Choice of 7 between £20 and £25 each 01708 737325

Articles for Sale

Beautiful First Holy Communion Vells with attached head-dresses, Choice of 7 between £20 and £25 each 01708 737325

Articles for Sale

Beautiful First Holy Communion Vells with attached head-dresses, Choice of 7 between £20 and £25 each 01708 737325

Articles for Sale

Beautiful First Holy Communion Vells with attached head-dresses, Choice of 7 between £20 and £25 each 01708 737325

Articles for Sale

Beautiful First Holy Communion Vells with attached head-dresses, Choice of 7 between £20 and £25 each 01708 737325

Articles for Sale

Beautiful First Holy Communion Vells with attached head-dresses, Choice of 7 between £20 and £25 each 01708 737325

Articles for Sale

Beautiful First Holy Communion Vells with attached head-dresses, Choice of 7 between £20 and £25 each 01708 737325

Articles for Sale

Beautiful First Holy Communion Vells with attached head-dresses, Choice of 7 between £20 and £25 each 01708 737325

Articles for Sale

Beautiful First Holy Communion Vells with attached head-dresses, Choice of 7 between £20 and £25 each 01708 737325

Articles for Sale

Beautiful First Holy Communion Vells with attached head-dresses, Choice of 7 between £20 and £25 each 01708 737325

Articles for Sale

Beautiful First Holy Communion Vells with attached head-dresses, Choice of 7 between £20 and £25 each 01708 737325

Articles for Sale

Beautiful First Holy Communion Vells with attached head-dresses, Choice of 7 between £20 and £25 each 01708 737325

Map of the area



**Park Lane Food Centre 77 Park Lane Hornchurch
RM11 1BH**

Map Reference: TQ5287NW
Date: 14/03/2011

Scale @ A4
1:1250

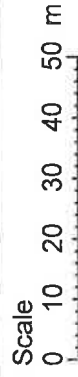

London Borough of Havering
Town Hall, Main Road
Romford, RM1 3BD
Tel: 01708 434343



Based upon the Ordnance Survey Mapping with the permission of the Controller of Her Majesty's Stationary Office. Crown © copyright. Unauthorised reproduction infringes Crown copyright and may lead to prosecution or civil proceedings. London Borough of Havering 100024327 2011

Current premises licence



Premises licence number

009366

Part 1 - Premises details

Postal address of premises, or if none, ordnance survey map reference or description

**Park Lane Food Centre
77 Park Lane
Hornchurch
RM11 1BH**

Where the licence is time limited the dates

Not applicable

Licensable activities authorised by the licence

Supply of alcohol

The times the licence authorises the carrying out of licensable activities

**Monday to Sunday
08:00 – 20:00**

The opening hours of the premises

**Monday to Sunday
08:00 – 23:00**

Where the licence authorises supplies of alcohol whether these are on and/ or off supplies

Off supplies only

1 of 7

Signed
Steve Bromley, Licensing Officer

Part 2

Name, (registered) address, telephone number and email (where relevant) of holder of premises licence

**Ms Hatice Sapkur
77 Park Lane
Hornchurch
Essex
RM11 1BH**

Registered number of holder, for example company number, charity number (where applicable)

Not applicable

Name, address and telephone number of designated premises supervisor where the premises licence authorises for the supply of alcohol

**Fazli Tubay
97 Kempe Road
Enfield
EN1 4QX**

Personal licence number and issuing authority of personal licence held by designated premises supervisor where the premises licence authorises for the supply of alcohol

**LN/200800914
London Borough of Enfield**

Mandatory Conditions

1. **No supply of alcohol may be made under the Premises Licence;**
 - (a) **at a time when there is no Designated Premises Supervisor in respect of the Premises Licence, or**
 - (b) **at a time when the Designated Premises Supervisor does not hold a Personal Licence or his Personal Licence is suspended.**
2. **Every supply of alcohol under the Premises Licence must be made or authorised by a person who holds a Personal Licence.**
3. (1) **The premises licence holder or club premises certificate holder shall ensure that an age verification policy applies to the premises in relation to the sale or supply of alcohol.**
(2) **The policy must require individuals who appear to the responsible person to be under 18 years of age (or such older age as may be specified in the policy) to produce on request, before being served alcohol, identification bearing their photograph, date of birth and a holographic mark.**

Annex 2 – Conditions consistent with the operating schedule

1. **A landline integrated security system is to be installed.**
2. **There will be no adult entertainment or services, activities or matters ancillary to the use of the premises that may give rise to concern in respect of children.**

3. All products containing alcohol to be kept inside the premises in a secure place.
4. The premises has CCTV cameras installed covering the entrance together with comprehensive internal viewing and the system is to be maintained regularly and recordings will be kept with the previous 31 days data. This information will be available to the police or other authorised persons upon request.
5. The premises fitted with a digital CCTV system which will conform to the following points.
 - 1) If the CCTV equipment is inoperative or not working to the satisfaction of the Police or Licensing Authority the premises shall not be used for licensable activities unless with prior agreement from the Police.
 - 2) Cameras must be sited to observe the entrance door both inside and outside the counter areas and all alcohol displays.
 - 3) Cameras on the entrances must capture full frame shots of the heads and shoulders of all people entering the premises i.e. Capable of identification – not less than 120% of the screen.
 - 4) Be capable of visually confirming the nature of the crime committed.
 - 5) Provide a linked record of the data, time and place of any image.
 - 6) Provide good quality images – colour during opening times.
 - 7) Operate under existing light levels within and outside the premises.
 - 8) Have the recording device located in a secure area or locked cabinet.
 - 9) Have a monitor to review images and recorded picture quality.
 - 10) Record images as near to real time as possible.
 - 11) Recorded images must be of sufficient quality that persons can be identified from the recorded pictures as well as the live view.
 - 12) Be regularly maintained to ensure continuous quality of image capture and retention.
 - 13) Comply with the Data Protection Act and any applicable British Security Industry
 - 14) Have signage displayed in the customer area to ensure an evidence trail is recorded and can be retrieved for evidential purposes.
 - 15) Digital images to be kept for 31 days.
 - 16) Checks should be frequently undertaken to ensure that the equipment performs properly and that all the cameras are operational and a log kept.
 - 17) The medium on which the images have been recorded should not be used when it has become apparent that the quality of the images has deteriorated.
 - 18) Access to recorded images should be restricted to those staff that need to have access in order to achieve the purposes of using the equipment.
 - 19) All access to the medium on which the images are recorded should be documented.
 - 20) Police will have access to images at any reasonable time.

3 of 7

Signed
 Steve Bromley, Licensing Officer

- 21) The equipment must have a suitable export method eg. CD/DVD writer so that the police can make an evidential copy of the data they require. This data should be in the native file format to ensure that no image quality is lost when making the copy. If this format is non-standard (ie. manufacturer proprietary) then the manufacturer should supply the replay software to ensure that the video on the CD can be replayed by the police on a standard computer. Copies must be made available to Police on request.
 - 21) Disclosure of the recorded images to third parties should only be made in limited and prescribed circumstances, law enforcement.
 - 22) Prosecution agencies, relevant legal representatives and people whose images have been recorded and retained.
-
6. A refusals book to be kept at the point of sale or electronically recorded on the till. A record must be kept on each occasion that a sale is refused. This book must be made available immediately to the Police and Local Authority when requested.
 7. Staff training records must be kept for a minimum period of 2 years. The records must be immediately available to the police and Local Authority upon request.
 8. The fire exit at the premises to be kept free of any obstacles.
 9. An electronically operated fire alarm system that complies with BS 5839: Part 1 to be installed.
 10. Emergency lighting systems to comply with BS 52266.
 11. Escape routes, exit notices and signs to be installed and maintained to their manufacturer's specifications.
 12. A fire risk assessment and emergency plan must be prepared.
 13. All fire fighting equipment to be maintained on a regular basis and placed at suitable locations in the premises.
 14. All safety certificates and inspection reports will be kept on site and available for inspection when requested.
 13. Signs to be displayed at the exit door of the premises requesting patrons to leave the premises quietly.
 14. Bottles and similar goods shall not be handled outside the premises in the late evening, night or early morning.
 15. Bins shall not be emptied outside the premises in the late evening, night or early morning.
 16. Rubbish from the premises shall be securely stored in a bin in a designated area.

17. No access to the premises by unaccompanied children under the age of 14 years after 21:00 unless accompanied by a person over the age of 18 years old.

18. All alcohol must be sold by the Designated Premises Supervisor or a person authorised by the Designated Premises Supervisor.

19. The Premises Licence holder shall attend a Child Protection awareness course.

19. Any concerns relating to children will be reported to Children's Services.

20. The Designated Premises Supervisor must undertake routine monitoring of the refusals records and record that is being done.

21. All staff that makes sales of alcohol received regular training (induction and refresher) this should include.

- i) Application for relevant proof of age scheme or similar
- ii) Penalties for selling to an underage person.
- iii) Asking for appropriate photographic identification. This must be either a passport, photographic driving licence or an identity card with the PASS logo (Proof of Age Standards Scheme)
- iv) The refusals process: and
- v) Any other information as deemed appropriate.

22. If the premises fall within the 'Drinking Control Area' a sign shall be displayed to inform the patrons that they are in a 'Drinking Controlled Area'. However, the premises are not able to prevent customers consuming alcohol purchased at the premises in the street.

24. Deliveries to the premises shall only be made during normal working hours.

Annex 3 – Conditions attached after a hearing by the Licensing Authority

1. All staff shall be suitably trained for their job function for the premise. The training shall be written into a programme, ongoing and under constant review, and must be available to a relevant Responsible Authority when called upon.
2. A properly specified and fully operational CCTV system shall be installed or the existing system maintained to a satisfactory standard. The system will incorporate a camera covering each of the entrance doors and be capable of providing an image which is regarded as 'identification standard' of all persons entering and/or leaving the premises. All other areas of risk are identified in the Operational Requirement shall have coverage appropriate to the risk.

5 of 7

Signed
Steve Bromley, Licensing Officer

3. The installation or upgrading of any CCTV system shall comply with current best practice. In addition the documentation listed below shall be included in a 'System File' which should be readily available for inspection by the relevant authority;
 - Site plan showing position of cameras and their field of view.
 - Code of Practice.
 - Performance specification e.g. storage capacity, image file size, IPS for each camera and purpose of each camera position
 - Operational requirement.
 - Incident log.
 - Maintenance records including weekly visual checks.
4. To obtain a clear head and shoulders image of every person entering the premises on the CCTV system, persons entering the premises should be asked to remove headwear, unless worn as part of religious observance.
5. The CCTV system shall incorporate a recording facility and all recordings shall be securely stored for a minimum of one calendar month. A system shall be in place to maintain the quality of the recorded image and a complete audit trail maintained. The system will comply with other essential legislation, and all signs as required will be clearly displayed. *The system will be maintained and fully operational throughout the hours that the premises are open for any licensable activity.* For premises using a video recording system, the cassette tapes shall be used on no more than 12 occasions to maintain the quality of the recorded image.
6. The positions of all CCTV cameras shall be clearly shown on a set of plans which should form part of the 'System File'. Any alteration to the system should only be carried out after consultation with and written approval of Havering Police and the Licensing Authority.
7. Prominent clear notices shall be displayed at the point of entry to the premises and in a suitable location at any points of sale, advising customers that they may be asked to produce evidence of their age.
8. All members of staff at the premises shall seek "credible photographic proof of age evidence" from any person who appears to be under the age of 18 years and who is seeking to purchase alcohol. Such credible evidence, which shall include a photograph of the customer, will include a passport, photographic driving licence, or Proof of Age card carrying a "PASS" logo.
9. Prominent, clear notices shall be displayed at the premises about the supply of alcohol to minors and the relevant offences involved.
10. That the premises shall adopt a Challenge 25 policy. This means that the premises would challenge anybody who attempts to buy an alcoholic drink who appears to be under the age of 21 and will not sell to such persons unless they can prove they are over 18 by a passport or photographic driving licence.
11. That the premises shall undertake to label all alcohol that is to be sold.
12. All occasions when persons have been refused service shall be recorded in writing and kept at the premises for six months.

Annex 4 – Plans

Project Title
 PARK LANE
 FOOD CENTRE
 13 PARK LANE
 DORMOUTH
 NR11 1BN

Drawing Title
 FLOOR PLANS

Reference
 AUGUST 2010

Scale
 1 / 100 at A4

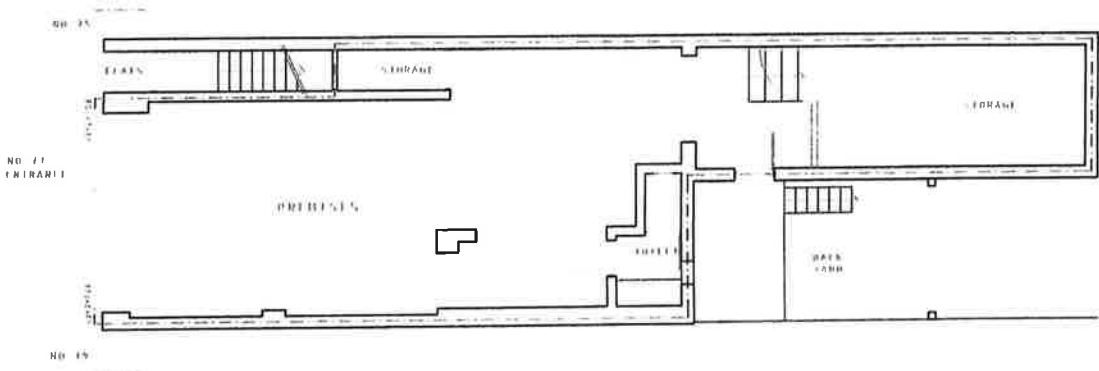

EXISTING PLAN

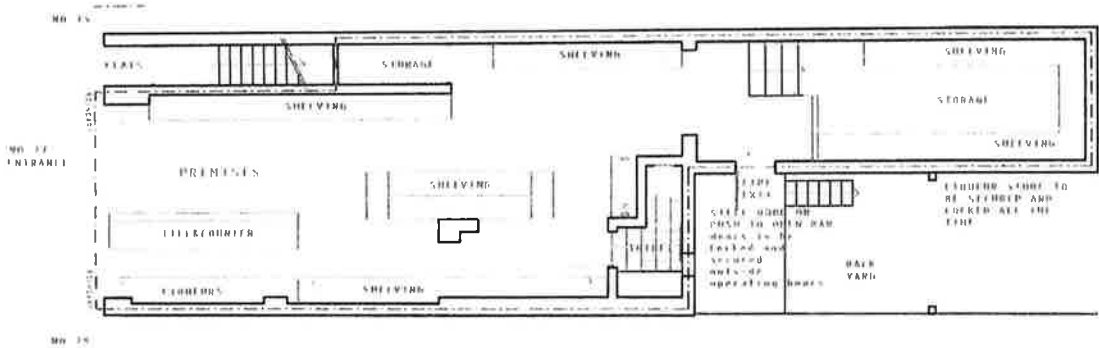

PROPOSED PLAN

NO. 15	NO. 17 (CENTRAL)	NO. 19
NO. 15	NO. 17 (CENTRAL)	NO. 19

Signed
 Steve Bromley, Licensing Officer

Application

Application to vary a premises licence under the Licensing Act 2003



PLEASE READ THE FOLLOWING INSTRUCTIONS FIRST

Before completing this form please read the guidance notes at the end of the form. If you are completing this form by hand please write legibly in block capitals. In all cases ensure that your answers are inside the boxes and written in black ink. Use additional sheets if necessary. You may wish to keep a copy of the completed form for your records.

I/We **MRS HATICE SAPKUR**

(Insert name(s) of applicant)

being the premises licence holder, apply to vary a premises licence under section 34 of the Licensing Act 2003 for the premises described in Part 1 below

Premises licence number 009366
--

Part 1 – Premises Details

Postal address of premises or, if none, ordnance survey map reference or description PARK LANE FOOD CENTRE, 77 PARK LANE , HORNCHURCH, ESSEX. RM11 1BH			
Post town	HORNCHURCH	Post code	RM11 1BH

Telephone number at premises (if any)	
Non-domestic rateable value of premises	£8100

Part 2 – Applicant details

Daytime contact telephone number	
E-mail address (optional)	
Current postal address if different from premises address	
Post Town	
Postcode	

Part 3 - Variation

Please tick yes

Do you want the proposed variation to have effect as soon as possible?

If not do you want the variation to take effect from

Day		Month		Year	

**Please describe briefly the nature of the proposed variation (Please see guidance note 1)
TO EXTEND THE PERMITTED HOURS FOR THE SALE OF ALCOHOL TO BE FROM 08.00 -
23.00 SUNDAY TO THURSDAY AND 08.00 - 00.00 MIDNIGHT FRIDAY AND SATURDAY.**

If your proposed variation would mean that 5,000 or more people are expected to attend the premises at any one time, please state the number expected to attend

Part 4 Operating Schedule

Please complete those parts of the Operating Schedule below which would be subject to change if this application to vary is successful.

Provision of regulated entertainment

Please tick yes

- a) plays (if ticking yes, fill in box A)
- b) films (if ticking yes, fill in box B)
- c) indoor sporting events (if ticking yes, fill in box C)
- d) boxing or wrestling entertainment (if ticking yes, fill in box D)
- e) live music (if ticking yes, fill in box E)
- f) recorded music (if ticking yes, fill in box F)
- g) performances of dance (if ticking yes, fill in box G)
- h) anything of a similar description to that falling within (e), (f) or (g) (if ticking yes, fill in box H)

Provision of entertainment facilities:

- i) making music (if ticking yes, fill in box I)
- j) dancing (if ticking yes, fill in box J)
- k) entertainment of a similar description to that falling within (i) or (j) (if ticking yes, fill in box K)

Provision of late night refreshment (if ticking yes, fill in box L)

Sale by retail of alcohol (if ticking yes, fill in box M)

In all cases complete boxes N, O and P

A

Plays Standard days and timings (please read guidance note 6)			Will the performance of a play take place indoors or outdoors or both – please tick (please read guidance note 2)	Indoors	<input type="checkbox"/>
				Outdoors	<input type="checkbox"/>
				Both	<input type="checkbox"/>
Day	Start	Finish			
Mon			Please give further details here (please read guidance note 3)		
Tue			State any seasonal variations for performing plays (please read guidance note 4)		
Wed			Non standard timings. Where you intend to use the premises for the performance of plays at different times to those listed in the column on the left, please list (please read guidance note 5)		
Thur					
Fri					
Sat					
Sun					

B

Films Standard days and timings (please read guidance note 6)			<u>Will the exhibition of films take place indoors or outdoors or both – please tick</u> (please read guidance note 2)	Indoors	<input type="checkbox"/>
				Outdoors	<input type="checkbox"/>
				Both	<input type="checkbox"/>
Day	Start	Finish	<u>Please give further details here</u> (please read guidance note 3)		
Mon					
Tue			<u>State any seasonal variations for the exhibition of films</u> (please read guidance note 4)		
Wed					
Thur			<u>Non standard timings. Where you intend to use the premises for the exhibition of films at different times to those listed in the column on the left, please list</u> (please read guidance note 5)		
Fri					
Sat					
Sun					

C

Indoor sporting events Standard days and timings (please read guidance note 6)			<u>Please give further details</u> (please read guidance note 3)
Day	Start	Finish	
Mon			
Tue			<u>State any seasonal variations for indoor sporting events</u> (please read guidance note 4)
Wed			
Thur			<u>Non standard timings. Where you intend to use the premises for indoor sporting events at different times to those listed in the column on the left, please list</u> (please read guidance note 5)
Fri			
Sat			
Sun			

D

Boxing or wrestling entertainments Standard days and timings (please read guidance note 6)			<u>Will the boxing or wrestling entertainment take place indoors or outdoors or both – please tick</u> (please read guidance note 2)	Indoors	<input type="checkbox"/>
Day	Start	Finish		Outdoors	<input type="checkbox"/>
Mon			<u>Please give further details here</u> (please read guidance note 3)	Both	<input type="checkbox"/>
Tue					
Wed			<u>State any seasonal variations for boxing or wrestling entertainment</u> (please read guidance note 4)		
Thur					
Fri			<u>Non standard timings. Where you intend to use the premises for boxing or wrestling entertainment at different times to those listed in the column on the left, please list</u> (please read guidance note 5)		
Sat					
Sun					

E

Live music Standard days and timings (please read guidance note 6)			Will the performance of live music take place indoors or outdoors or both – please tick (please read guidance note 2)	Indoors	<input type="checkbox"/>
				Outdoors	<input type="checkbox"/>
				Both	<input type="checkbox"/>
Day	Start	Finish	Please give further details here (please read guidance note 3)		
Mon					
Tue					
Wed			State any seasonal variations for the performance of live music (please read guidance note 4)		
Thur					
Fri			Non standard timings. Where you intend to use the premises for the performance of live music at different times to those listed in the column on the left, please list (please read guidance note 5)		
Sat					
Sun					

F

Recorded music Standard days and timings (please read guidance note 6)			<u>Will the playing of recorded music take place indoors or outdoors or both – please tick</u> (please read guidance note 2)	Indoors	<input type="checkbox"/>
				Outdoors	<input type="checkbox"/>
				Both	<input type="checkbox"/>
Day	Start	Finish			
Mon			<u>Please give further details here</u> (please read guidance note 3)		
Tue					
Wed			<u>State any seasonal variations for the playing of recorded music</u> (please read guidance note 4)		
Thur					
Fri			<u>Non standard timings. Where you intend to use the premises for the playing of recorded music at different times to those listed in the column on the left, please list</u> (please read guidance note 5)		
Sat					
Sun					

G

Performances of dance Standard days and timings (please read guidance note 6)			Will the performance of dance take place indoors or outdoors or both – please tick (please read guidance note 2)	Indoors	<input type="checkbox"/>
Day	Start	Finish		Outdoors	<input type="checkbox"/>
Mon			Please give further details here (please read guidance note 3)	Both	<input type="checkbox"/>
Tue					
Wed			State any seasonal variations for the performance of dance (please read guidance note 4)		
Thur					
Fri			Non standard timings. Where you intend to use the premises for the performance of dance at different times to those listed in the column on the left, please list (please read guidance note 5)		
Sat					
Sun					

H

Anything of a similar description to that falling within (e), (f) or (g) Standard days and timings (please read guidance note 6)			<u>Please give a description of the type of entertainment you will be providing</u>		
Day	Start	Finish	<u>Will this entertainment take place indoors or outdoors or both – please tick</u> (please read guidance note 2)	Indoors	<input type="checkbox"/>
Mon				Outdoors	<input type="checkbox"/>
				Both	<input type="checkbox"/>
Tue			<u>Please give further details here</u> (please read guidance note 3)		
Wed					
Thur			<u>State any seasonal variations for entertainment of a similar description to that falling within (e), (f) or (g)</u> (please read guidance note 4)		
Fri					
Sat			<u>Non standard timings. Where you intend to use the premises for the entertainment of a similar description to that falling within (e), (f) or (g) at different times to those listed in the column on the left, please list</u> (please read guidance note 5)		
Sun					

I

Provision of facilities for making music Standard days and timings (please read guidance note 6)			<u>Please give a description of the facilities for making music you will be providing</u>	
			Will the facilities for making music be indoors or outdoors or both – please tick (please read guidance note 2)	
Day	Start	Finish	Indoors	<input type="checkbox"/>
			Outdoors	<input type="checkbox"/>
			Both	<input type="checkbox"/>
Mon			Please give further details here (please read guidance note 3)	
Tue			State any seasonal variations for the provision of facilities for making music (please read guidance note 4)	
Wed			Non standard timings. Where you intend to use the premises for provision of facilities for making music at different times to those listed in the column on the left, please list (please read guidance note 5)	
Thur				
Fri				
Sat				
Sun				

J

Provision of facilities for dancing Standard days and timings (please read guidance note 6)			<u>Will the facilities for dancing be indoors or outdoors or both – please tick</u> (see guidance note 2)	Indoors	<input type="checkbox"/>
				Outdoors	<input type="checkbox"/>
				Both	<input type="checkbox"/>
			<u>Please give a description of the facilities for dancing you will be providing</u>		
Day	Start	Finish			
Mon			<u>Please give further details here</u> (please read guidance note 3)		
Tue					
Wed			<u>State any seasonal variations for providing dancing facilities</u> (please read guidance note 4)		
Thur					
Fri			<u>Non standard timings. Where you intend to use the premises for the provision of facilities for dancing at different times to those listed in the column on the left, please list</u> (please read guidance note 5)		
Sat					
Sun					

K

Provision of facilities for entertainment of a similar description to that falling within i or j Standard days and timings (please read guidance note 6)			<u>Please give a description of the type of entertainment facility you will be providing</u>		
Day	Start	Finish	<u>Will the entertainment facility be indoors or outdoors or both – please tick</u> (please read guidance note 2)	Indoors	<input type="checkbox"/>
Mon				Outdoors	<input type="checkbox"/>
				Both	<input type="checkbox"/>
Tue			<u>Please give further details here</u> (please read guidance note 3)		
Wed					
Thur			<u>State any seasonal variations for the provision of facilities for entertainment of a similar description to that falling within i or j</u> (please read guidance note 4)		
Fri					
Sat			<u>Non standard timings. Where you intend to use the premises for the provision of facilities for entertainment of a similar description to that falling within i or j at different times to those listed in the column on the left, please list</u> (please read guidance note 5)		
Sun					

L

Late night refreshment Standard days and timings (please read guidance note 6)			Will the provision of late night refreshment take place indoors or outdoors or both – please tick (please read guidance note 2)	Indoors	<input type="checkbox"/>
Day	Start	Finish		Outdoors	<input type="checkbox"/>
				Both	<input type="checkbox"/>
Mon			Please give further details here (please read guidance note 3)		
Tue					
Wed			State any seasonal variations for the provision of late night refreshment (please read guidance note 4)		
Thur					
Fri			Non standard timings. Where you intend to use the premises for the provision of late night refreshment at different times, to those listed in the column on the left, please list (please read guidance note 5)		
Sat					
Sun					

M

Supply of alcohol Standard days and timings (please read guidance note 6)			Will the supply of alcohol be for consumption (Please tick box) (please read guidance note 7)	On the premises	<input type="checkbox"/>			
				Off the premises	<input checked="" type="checkbox"/>			
				Both	<input type="checkbox"/>			
Day	Start	Finish	State any seasonal variations for the supply of alcohol (please read guidance note 4) NONE					
Mon	08.00	23.00						
Tue	08.00	23.00						
Wed	08.00	23.00						
Thur	08.00	23.00						
Fri	08.00	00.00						
Sat	08.00	00.00						
Sun	08.00	23.00						
						Non-standard timings. Where you intend to use the premises for the supply of alcohol at different times to those listed in the column on the left, please list (please read guidance note 5) NONE		

N

Please highlight any adult entertainment or services, activities, other entertainment or matters ancillary to the use of the premises that may give rise to concern in respect of children (please read guidance note 8)
NONE

O

Hours premises are open to the public Standard days and timings (please read guidance note 6)			State any seasonal variations (please read guidance note 4) NONE
Day	Start	Finish	
Mon	07.00		Non standard timings. Where you intend the premises to be open to the public at different times from those listed in the column on the left, please list (please read guidance note 5) NONE
		23.00	
Tue	07.00		
		23.00	
Wed	07.00		
		23.00	
Thur	07.00		
		23.00	
Fri	07.00		
		00.00	
Sat	07.00		
		00.00	
Sun	07.00		
		23.00	

Please identify those conditions currently imposed on the licence which you believe could be removed as a consequence of the proposed variation you are seeking
 NONE

Please tick yes

- I have enclosed the premises licence
- I have enclosed the relevant part of the premises licence

If you have not ticked one of these boxes please fill in reasons for not including the licence, or part of it, below

Reasons why I have failed to enclose the premises licence or relevant part of premises licence

P Describe any additional steps you intend to take to promote the four licensing objectives as a result of the proposed variation:

a) General – all four licensing objectives (b,c,d,e) (please read guidance note 9)

WE WILL OPERATE OUR BUSINESS IN A RESPONSIBLE MANNER AT ALL TIMES AND ACTIVELY PROMOTE THE LICENSING OBJECTIVES.

b) The prevention of crime and disorder

ALL EXISTING POLICIES & CONDITIONS TO REMAIN IN FORCE.

c) Public safety

ALL EXISTING POLICIES & CONDITIONS TO REMAIN IN FORCE.

d) The prevention of public nuisance

ALL EXISTING POLICIES & CONDITIONS TO REMAIN IN FORCE.

e) The protection of children from harm

ALL EXISTING POLICIES & CONDITIONS TO REMAIN IN FORCE.

Please tick yes

- I have made or enclosed payment of the fee
- I have sent copies of this application and the plan to responsible authorities and others where applicable
- I understand that I must now advertise my application
- I have enclosed the premises licence or relevant part of it or explanation
- I understand that if I do not comply with the above requirements my application will be rejected

IT IS AN OFFENCE, LIABLE ON CONVICTION TO A FINE UP TO LEVEL 5 ON THE STANDARD SCALE, UNDER SECTION 158 OF THE LICENSING ACT 2003 TO MAKE A FALSE STATEMENT IN OR IN CONNECTION WITH THIS APPLICATION

Part 5 – Signatures (please read guidance note 10)

Signature of applicant (the current premises licence holder) or applicant’s solicitor or other duly authorised agent (please read guidance note 11). **If signing on behalf of the applicant please state in what capacity.**

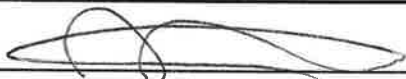
Signature	
Date	10/2/2011
Capacity	AUTHORISED LICENSING CONSULTANTS

Where the premises licence is jointly held signature of 2nd applicant (the current premises licence holder) or 2nd applicant’s solicitor or other authorised agent (please read guidance note 12). **If signing on behalf of the applicant please state in what capacity.**

Signature	
Date	
Capacity	

Contact name (where not previously given) and address for correspondence associated with this application (please read guidance note 13)

G & T LICENSING CONSULTANTS,
C/O 316 DAGENHAM ROAD,
ROMFORD,
ESSEX
RM7 0TB

Post town	ROMFORD	Post code	RM7 0TB
Telephone number (if any)	07810 826778		
If you would prefer us to correspond with you by e-mail your e-mail address (optional) gtlicensingconsultants@googlemail.com			

Interested party representations

Mr J Sims
86, CLYDESDALE ROAD
HORNCURCH
ESSEX
RM11 1AQ

27TH FEBRUARY 2011

Steve Bromley
London Borough of Havering
Licensing Section, Public protection
Mercury House
Mercury Gardens
Romford RM1 3SL

Dear Sir,

Re:- Variation of the existing Premises (alcohol) Licence – 77 Park Lane, Hornchurch, RM11 1BH.

I refer to the above variation to the existing alcohol licence, and hereby give my reasons as to why this must be refused under all four Licensing objectives (the prevention of crime and disorder, public safety, the prevention of public nuisance, and the protection of children from harm).

Alcohol problems in the immediate area have increased substantially within the last few years. Local residents have endured anti-social behaviour from the unruly element in our society, many of who congregate around the junction of Park Lane with Clydesdale Road, (close to the existing main off-licence) drinking their ill gotten gains. I have discussed this with council staff and councillors, together with the police on many occasions, looking for a way around this increasing problem. It was considered at one stage by the police, for an ultraviolet marker to be placed on the bottom of the bottles and cans - to ascertain from what premises the alcohol was being purchased. Residents of Clydesdale Road – including myself – have had the 'misfortune' of youths jumping on and off our vehicles (trainer prints and witnesses in evidence) whilst others have had their wing mirrors broken, and windscreen wipers positioned up in the air. The anti-social behaviour also includes 'mock fighting', 'street football' - amongst the cars - loud shouting and obscene language throughout the late / early hours. Smashed bottles and discarded cans have further been in evidence since the existing alcohol licence was approved in late 2010 – against residents recommendations. Youths also openly congregate in the Park Lane Recreation ground, their shouting and obscene language heard throughout the early hours. They have been seen openly urinating in the park grounds, leaving behind smashed bottles and empty cans together with other 'waste', they are a complete nuisance – which the council and police have yet to deal with in a satisfactory manner. I have on many occasions had reason to ask the PCSO teams of Hylands ward and Romford Ward to increase patrols in the early hours – to help stamp out the crime and disorder currently seen. Graffiti has also increased further - on walls / lamp posts / and nearby shop shutters – making the area look like that of a troubled inner London borough. Council rubbish bins have been overturned on many occasions – even more so since the licence was first approved. Many of the youths causing trouble appear to be aged between 11 to 18. Local residents feel unable to confront the individuals in fear of their own safety and the repercussions that may occur if they did so.

It is also my understanding that the shop owners / licence holders have recently been found to be selling alcohol later than the hours approved by the council – in fragrant breach of the rules and regulations agreed by the applicants when the licence was firstly approved. I have also been made aware that the applicant has not 'marked' the alcohol sold on the premises in order that empty cans / smashed bottles etc. can be traced back to their shop – when I believe this was also one of the conditions on the awarding of the original licence. This all shows that the licence holders do not appear to be honest, respectable, nor trustworthy individuals. Furthermore, the off licence in the same stretch of shops regularly closes around 19:00-20:00 this is because the trade is insufficient to warrant a later opening, and also because of under-age youths demanding alcohol be sold to them.

Furthermore, I believe further scrutiny must be applied to the 'licence holders'. This is because whilst only Ms Hatice Sapkur is applying in her sole name – other names are later added without I believe a full background check as to their suitability. One must also not forget the threats and intimidation (made by one of the approved 'late' male applicants) to the proprietor of the near newsagents for his opposition to the first application. Yet again, I believe this proves the applicants unsuitability for such a licence.

In more formal terms, the proposal would also - by reasons of extra noise and disturbance caused by customers entering and leaving the premises, vehicles parking and manoeuvring, particularly during the late evening / early morning hours of operation – be unacceptably detrimental to the amenities of occupiers of adjacent and opposite properties, contrary to policies DC55 and DC61 of the LDF Development Control Policies Development Plan Document – and also I believe of policies DC3 and DC4.

I feel that the variation to the licence would exacerbate problems further, and ask that this be refused. It is already clear, that the licence should not have been approved in the first place.

Yours sincerely

Nb. bearing in mind the threats and intimidation made by one of the 'applicants' to the proprietor of the nearby newsagents who was against the issuing of the original licence, I ask that once again – anyone wishing to speak up at the licensing meeting, should be able to do so anonymously, and all names, signatures and addresses of those people sending in letters opposing the variation should be suitably redacted.

Steve Bromley

From: Steve Bromley
Sent: 07 March 2011 10:36
To: Steve Bromley
Subject: FW: 77 Park Lane, Hornchurch, Essex RM11 1BH

From: Pam Screech [mailto:pamscreech@googlemail.com]
Sent: 06 March 2011 17:19
To: Steve Bromley
Subject: 77 Park Lane, Hornchurch, Essex RM11 1BH

3 Hillcrest Road,
Hornchurch,
Essex
RM11 1EF

6/3/2011

Dear Mr Bromley

Ref SJB009981

Thank you for your letter referring to the above reference for the variation of the Premises Licence Application at 77 Park Lane Hornchurch Essex.. We are writing to oppose the application on the grounds as given below.

The Prevention of Crime and Disorder being persons acting disorderly under the influence of alcohol late at night and causing disruption in this area. Leading to anti social behaviour persons causing criminal acts such as extra break ins to home and cars in this area.

The Prevention of of Public Nuisance being extra noise and disruption at night. We suffer at present with people on their way home from the Romford clubs and Bars at all hours, especially Friday and Saturday nights. This would lead to more car doors slamming and people shouting knowing there was an off licence open until 11 and 12pm and able to stop off.

Public Safety would be endangered with more traffic through Park Lane after 8pm Friday and Saturday Nights especially during the Summer months.

The Protection of Children from Harm we now have the added pressure customers buying cans of beer at 8.20am taking the cans back to their car and drinking it and then driving off. We have in effect 5 -6 schools in this area wiith children are on their way to school at this time every morning. This is something we didnt have on our doorstep before.

The Licensee has already breached his contract by selling after the hours of 8pm, we feel he will do this after 11pm during the week and after 12pm Friday and Saturday nights, he has betrayed his trust.

The off licence at the corner of Park Lane and Hillcrest Road closes at 9pm at the request of the Police and Council following problems at night, so why should the variation of this license be granted.

Licensing policy no 12 says "We are committed to protecting the amenity of residents and businesses in the vicinity of licensed premises". In view of the above he should have his licence revoked not extended.

This is primarily a residential area which is comparatively safe and we wish to keep this way. Please take this into consideration.

Yours sincerely

Mrs Pam Screech
Mr Edwin Screech

11th March 2011

109 Park Lane
Hornchurch
Essex
RM11 1EG

Re: Park Lane Food Centre
77 Park Lane, Hornchurch RM11 1BH

Dear Sir or Madam,

As a resident of Park Lane for over 40 years, I totally object to the Proposed extended license hours at the above premises.

We already get the people returning from Romford late at night, if they are able to obtain more drinks on their way through Park Lane it could so easily then cause more crime and disorder and public nuisance. Public safety and property could also be affected.

In the last few years the number of youths congregating along Park Lane has slightly decreased. The proposed longer hours will once again see many youngsters hanging around this area.

So please turn this application down for the benefit of local residents and their families.

Yours Sincerely



Mrs Joy Emerson

Received 11th MARCH 11

DUPLICATE
HARD COPY

This letter supersedes
previous correspondence

97 Park Lane
Hornchurch
Essex
RM11 1EG

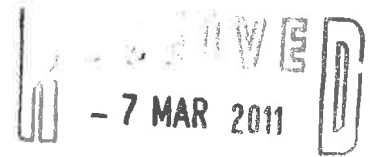

7th March 2011

The London Borough of Havering Licensing Team
Public Protection
Mercury House
Mercury Gardens
Romford
RM1 3SL

Dear Sirs

Re: Refusal of Application – 77 Park Lane

I write to express my views why the application to open licensed premises in the parade of shops in Park Lane between Park Crescent and Hillcrest Road should be refused:-

- ❖ There was a bricked-off garden area at the top of Clydesdale Road which abuts Park Lane. This area was demolished because large gatherings of people would congregate late and night after buying alcohol from the off license opposite and cause a disturbance. Police would frequently arrive to disperse such gatherings.
 - **We were so pleased when all these gatherings and disruptions stopped and we could again have peace in Park Lane. We feel agreeing to this license would start gatherings of drunken persons up again at an even later time.**

- ❖ There is an off license in Park Lane and also a Wine Shop at the junction of Park Lane and Albert Road.
 - **We feel that there are enough liquor outlets in the immediate area and therefore find the need for another store unnecessary.**

Police are often clearing large gatherings of people from the park in Park Lane late at night that are carrying cans of drink.

- **We feel that this disturbance would continue and could encourage drifters and alcoholics to break into the park and take up residence permanently, leaving their broken bottles behind them and if on drugs could leave their users needles and drug evidence in the park where children play which could result in children being infected; causing bad press for the borough. Children would then avoid the park because of unsavoury characters hanging about shouting obscenities. Dealers may approach the children to offer drugs.**
- **There is also a school in Park Lane and drifters and alcoholics may try to sleep in the grounds, leaving their cans and drug using equipment there or throw it over the fence into the playground where children will arrive in the morning to be greeted by broken glass and needles. Again children could be infected or approached by dealers.**
- ❖ **The Office license in Park Lane has been known to sell drink to the under-aged.**
 - **Police are often called to check the ages of the persons buying alcohol and we feel that this could continue into the early hours if this license was granted as the license application is from 8 – 1.a.m. on Saturdays.**
- ❖ **Park Lane is already used as a cut-through and we have the ‘pleasure’ of police sirens most nights.**
 - **Opening these licensed premises would increase this activity in the early hours.**
- ❖ **The Durham Arms in Brentwood Road sits at the top of Park Lane and there are another two public houses nearby in Brentwood Road.**
 - **We already suffer the wroth when these public houses turn out and would not like it to start up again at 1 a.m.!**

I think the residence of Park Lane have suffered enough and do not need the additional pressure of further licensed premises opening until 1 a.m.

Finally, due to unreasonable behaviour late at night where the police have had to be called on numerous occasions, the off license proprietor based at the end of the parade of shops in Park Lane has made a decision to close earlier than his license allows; to prevent large groups of youths causing disturbances late into the night. This action has stemmed the unruly gatherings in the area and I feel having alcohol available until 11 p.m. Sunday – Thursday and midnight Friday and Saturday would encourage past activities to resurrect themselves and indeed the proprietor of the off license may decide to open up until late again, as 77 Park Lane would be taking away their trade and then there would be enormous trouble.

There is already an increase in the number of youths congregating in the vicinity of 77 Park Lane area and on several occasions I have been asked by under-aged youths to go into the shop and buy cigarettes and alcohol. As the lighter evenings will soon be upon us, the purchases of alcohol could be taken and consumed in Park Lane park nearby where large gatherings of youths have been rounded up by the police in the past and encouraged to drink elsewhere **and they do not go quietly!**

Please take the responsible decision and refuse this application.

I await your response

Yours faithfully

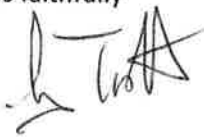
A handwritten signature in black ink, appearing to read 'G E D Trott', written over a faint, illegible typed name.

G E D Trott (Mrs)

p.s. We have also had a letter delivered from the police regarding this request for extended sales which shows their concern.

Steve Bromley

From: Maddie Stephens [MStephens@woodbrookual.co.uk]
Sent: 28 February 2011 14:35
To: Steve Bromley
Subject: 77 PARK LANE - APPLICATION TO EXTEND LICENSING HOURS

Dear Steve,

I am a resident of the area for many years and am very concerned about the application to extend opening hours at 77 Park Lane, Hornchurch.

Allowing the off-licence to stay open later can only encourage under - age youngsters to try to obtain drink and so I feel strongly that this further application should be refused, if only to attempt to keep them safe from under-age drinking.

As the lighter evenings approach, already youths are starting to hang about on street corners and indeed outside the premises at 77 Park Lane causing a lot of noise and on occasions, public nuisance.

As the premises are on the route to and from Romford, this area and surrounding streets often experience late night revellers making their way home and having an off-licence open will encourage these drunkards to drink again in the street causing noise, disruption and possibly crime.

I believe that extending the opening hours will not keep our neighbourhood safe from vandalism and possibly crime and would point out that the original application for a late night opening licence was refused on very similar grounds.

Kind regards
Mrs M Stephens
118 Clydesdale Road

~~~~~

Woodbrook Underwriting Agencies Ltd  
Lake Meadows Business Park  
13 Woodbrook Crescent  
Billerica, Essex CM12 0EQ

Tel: 01277 633166

Authorised and Regulated by the Financial Services Authority

IMPORTANT - This document contains confidential information and is intended only for the individual named. If you are not the named addressee you should not disseminate, distribute or copy this email. Please notify the sender immediately by email if you have received this email by mistake and delete this email from your system.

Email transmission cannot be guaranteed to be secure or error-free as information could be intercepted, corrupted, lost, destroyed, arrive late or incomplete, or contain viruses. The sender therefore does not accept liability for any errors or omissions in the contents of this message or attached documents or for any damage suffered by your computer system caused by any errors or viruses in the email message or any attached documents.

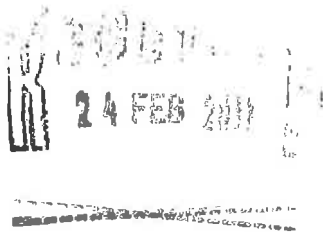

122 Park Lane  
Hornchurch  
Essex  
RM11 1BE

21st February 11

**Re: Application to extend Licensed Hours at Park Lane Food Centre.**

Dear Sir,

I have just been made aware of the application to extend the Licensed Hours at Park Lane Food Centre to 11pm Sunday to Thursday and to midnight on Friday and Saturday and would like to submit my reasons why this application should be refused.

1. I live directly opposite 77 Park Lane which is predominantly a residential area and I am concerned that what is already a fairly noisy road late at night with people returning from Romford by foot or car will become much worse, as people stop to buy alcohol, and instead of passing by will continue with their loud conversations, arguments, singing etc., or cars leaving engines running, car radios blaring as a passenger/companion pops into the shop.
2. Parking in Park Lane directly opposite the row of shops is already a problem. During the day I understand local business rely on passing traffic, and in the evening we already have a Chinese Takeaway and The Rose Off License, which are open later into the evening. Additional cars parking on a busy but narrow stretch of road (with cars parked both sides) will increase the risk of accidents to pedestrians and road users.
3. I am also concerned that the risk of vandalism will increase. In the past 5 years I have twice had my car vandalised (the wing mirror on the pedestrian side knocked off both times) and have seen other cars in the street also affected. Since Park Lane Food Centre has been open we are increasingly seeing groups of youth hanging around quite late into the evening. One occasion a group of about 20 were outside at 9.30pm in the evening, which was quite intimidating. I fear this will increase as we go into summer and with alcohol available until midnight residents will suffer from noise and anti social behaviour.
4. I already see discarded bottles (sometimes broken) and cans in the street but fear again this will greatly increase causing possibly danger to pedestrians and also pets.

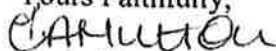
Yours Faithfully,  
  
Linda Hutton



RECEIVED  
25 FEB 2011

13, Hillcrest Rd  
Hornchurch  
Essex.  
RM11 1EF  
22nd Feb 2011

Dear Mr Bromley.

Re: Planning Application  
77 Park Lane

With reference to the above application, I wish to object to an extension of licensing hours at 77 Park Lane.

At present there are a number of reasons why this application should be refused, mainly as more young people are gathering outside this shop, there could be problems with crime and disorder. - As the clocks change and the weather improves the light hours will encourage groups to congregate and cause nuisance to the residents and neighbours. There are sufficient places to buy alcohol after hours and this extension is not needed. Public safety is also an issue as large groups of youths etc can be very intimidating when walking past this shop. I therefore feel that the opening hours & licensing hours of this shop are sufficient and do not need to be extended.

Yours faithfully

Ms. V. Callaghan .55

P.S. Please acknowledge receipt of this letter.

## Steve Bromley

---

**From:** Veronica Hill [v.hill67@ntlworld.com]  
**Sent:** 07 March 2011 09:33  
**To:** Steve Bromley  
**Cc:** georgina.galpin@havering.co.uk  
**Subject:** OBJECTION RE: 77 PARK LANE, HORNBURCH

I understand that a further application has been submitted to increase the off-licensing trading hours of the above premises.

When I submitted a previous objection I felt that the existing off-licence in the parade provided enough facilities for purchasing alcohol and I am concerned that disorder and crime will result if an extension is allowed.

There are a lot of bored youngsters around and I am concerned and worried that harm to these children will occur as a result of more alcohol being sold late evening.

We already endure a lot of dumped alcohol cans and bottles being dumped along and in our local roads and the glass bottles are a public safety hazard (often broken) and create an additional public nuisance.

Two nights ago drunken teenagers came along our road kicking off wing mirrors on the cars.  
(crime report no. 190 6.2.2011)

Thank you for your time and attention.

Veronica Hill (Mrs) 162 Hillcrest Road, Hornchurch, Essex, RM11 1EA

RECEIVED  
- 3 MAR 2011

Mrs Mrs. Downs  
69 CLYDEDALE ROAD  
HORNCHURCH  
RM11 1AJ  
2-3-11.

We are writing to object to the extended licensing application to 77 Parkway, Hornchurch on the grounds as stated below.

We live at the top end of Clydesdale Road near Parkway and we have in recent years with the help of councillors and the police managed to clear all the groups of youngsters away from hanging around and causing a nuisance.

We do not want extended licensing hours again attracting youths to this area again.

Also bearing in mind the owners of the said shop have already been caught 2-3 times selling alcohol after the 8pm watershed.

Also if they want alcohol Tesco is only 5-10 mins walk away and open till 10pm which is sufficient for this area.

We also have heard rumours that he is after purchasing the cafe along the same parade for a kebab shop that we suspect is why he requires these late hours.

This is a residential area we do not want this

Yours faithfully  
Mrs Downs

Housing and Public Protection  
FAO Mr Steve Bromley  
London Borough of Havering  
Mercury House  
Mercury Gardens  
Romford  
RM1 3SL

6, Hillcrest Road  
Hornchurch  
Essex  
RM11 1EB

4 March 2011

Dear Mr Bromley

**APPLICATION TO VARY LICENSED PREMISES 77 PARK LANE**

We are writing with great concern regarding the above application to vary licensing hours until 11pm Monday to Friday and midnight on Saturday and Sunday. We would strongly request that this application be refused for the reasons specified below.

Since these premises have started trading as an off-license our worst fears have been realised. Anti-social behaviour has increased in our residential area. A large number of youths hang around outside the premises, drinking, smoking and urinating. They also sit on the walls adjacent to the premises, insulting and intimidating passers-by. We have not seen youths gathering outside Rose Wine, the other licensed outlet on the parade.

We believe that alcohol has been sold from the premises past 8pm, the agreed hours set at the last hearing. We are therefore concerned that if the licensee has broken existing trading conditions they may sell alcohol into the early hours of the morning, if granted late trading hours. We also worry that may sell to the large number of under age-youths hanging around outside the premises.

We are also concerned that the applicant for this license variation is a woman with a young child, bearing in mind the large number of youths who loiter outside the premises.

We are very worried that as the summer months will soon be upon us, the situation will get much worse, causing sleep deprivation for residents, and increased fears for our safety and well-being. We don't wish for our residential community to suffer further by more alcohol being introduced into the area and exacerbating the increased anti-social behaviour. We also have concerns whether there will be additional policing available to deal with the anti-social behaviour and protect residents' safety.

Yours sincerely

Mr P and Mrs J Haworth

## Steve Bromley

---

**From:** ribbons8@aol.com  
**Sent:** 04 March 2011 09:38  
**To:** Steve Bromley  
**Subject:** Re: 77 Park Lane

Dear Steve,

I am writing to you with regards to the extension of hours applied for at the above premises. I live at 80 Globe Road and already have suffered a large amount of anti social behaviour as a result of alcohol consumed whilst people walk down my road on the weekends. Bollards are kicked over, cars are punched and empty alcohol bottles are discarded everywhere, which - as Hylands primary school is nearby - broken glass is a health hazard to the children.

During the summer months Hylands park is a hub for youths to gather and drink copious amounts of alcohol which causes a huge disturbance for the residents even into the early hours of the morning. I have been in constant contact with Martin Stanton who looks after parks and open spaces and indeed our local Safer Neighbourhood Team, and together we have worked hard to try and eradicate the anti social behaviour that comes along with children drinking alcohol. But obviously the more accessible it is, the easier it is to purchase, and I have received information that alcohol is being purchased in this area of Park Lane already.

As a serving police officer, I have a high tolerance level and am not exaggerating my experiences where I live. I do strongly believe that extending the hours to 77 Park Lane will have a detrimental effect on local residents as crime and disorder will increase, therefore public safety will be compromised together with the fact that I believe children will be purchasing alcohol from this premises putting them in harms way. I also believe the proposed hours would attract all sorts of unsavoury characters and encourage loitering perhaps leading to criminal behaviour.

I do hope the council see sense with this ridiculous application, bearing in mind resources are already stretched to a maximum and this unnecessary extension will be of no benefit to anyone other than the proprietors bank account.

Many thanks for your time,

Donna Ribbons

Dear Mr Bromley,

This email is to register my concerns and request that the above application should be rejected .

You will be aware already that Park Lane already has an Off License at the end of the parade of shops that has extended hours. This in itself presents problems as there are often groups of young people collected outside late in the evening.

Whilst in general behaviour is good there are times when it is not. There appears to be little in hand by the police or local authority to address this issue. Additionally there is also Tesco which has extended opening hours just around the corner.

As a word of caution youngsters also tend to sit on the wall by the vets which is next to 77 Park Lane as it presents a convenient place to sit. I have already been asked by underage people to get cigarettes and alcohol for them which I have refused and with the subsequent abuse. This does not bother me but I would understand if it did others.

So in summary I do not see this request as either necessary or desirable in a residential area where we already have some issues. The UK government itself is showing concerns around drinking and availability and this feels to fly in the face of that stance.

I would therefore just ask that consideration is given to the points I raise and that this forms part of the overall decision process.

Many thanks

Dave Goldstone  
33 Hillcrest Road  
Hornchurch

Resident since 1979

**Steve Bromley**

---

**From:** pat [silvergrey48@hotmail.com]  
**Sent:** 01 March 2011 19:16  
**To:** Steve Bromley  
**Subject:** Alcohol Licence

37. Hillcrest Road

Hornchurch

Essex

Rm11 1ef

01-03-11

Dear Mr Bromley.

As my address shows if you permit a late alcohol licence it will be very upsetting for the surrounding area.

It will increase crime and disorder

Members of the public would be affected

At the top of Hillcrest Road is Hylands park where many youngsters congregate more in the lighter evenings they come down Hillcrest to the shop to buy alcohol then back up Hillcrest to go to Hylands on their way we get stones thrown at our windows our cars scratched side mirrors broken we have shouting and screaming if a late licence is granted till midnight we will have these problems in the early hours of the morning.

So as not to encourage these negative behaviours I ask that the licence not be extended.

Patricia Woolacott

## Steve Bromley

---

**From:** Dave Snazel [dsnazel@live.co.uk]  
**Sent:** 28 February 2011 18:10  
**To:** Steve Bromley  
**Subject:** 77 Park Lane

Dear Mr Bromley

I want like to add my objection to the application to vary the licence for 77 Park Lane, this shop is mainly in a residential area and since it has been open there has been an increase in youth's gathering outside the shop There has always been a few that hung around the shops that were already there but there does seem to have been an increase recently.

If people do wish to buy alcohol at the moment after 8pm they can use the pub on the corner of Park Lane and Brentwood Rd or use the Tesco's at the other end of Park Lane and Hornchurch Rd, no one wants to stop any one from making a living especially in the present economic climate but the wishes of the local residents do also need to be considered.

Kind Regards

Dave Snazel  
30 Hillcrest Rd  
RM 11 1EB



## Steve Bromley

---

**From:** Linda Smith [Linda.Smith@roadways.co.uk]  
**Sent:** 23 February 2011 15:06  
**To:** Steve Bromley  
**Subject:** The prevention of public nuisance

*Application to vary licensed premises – 77 Park Lane*

*I am writing to request that the council decline the application to extend a license to sell alcohol at 77 Park Lane.*

*I live at 107 Park Lane directly opposite the park. We already have problems of youths congregating in this area and particularly in the summertime they are often found drunk and disorderly and causing a public nuisance. We already have one off license on Park Lane whereby teenagers can be found either asking older teenagers to purchase alcohol for them or obtaining it themselves we really do not need another one open until 11.00pm and midnight.*

*There is also another off license at the end of park lane at the end of Albert Road which is licensed until late.*

*Please consider this application very carefully your residents are depending on you to make the right decision in keeping our neighbourhood as safe as possible.*

*Kind regards*

*Linda Smith  
107 Park Lane  
Hornchurch  
Essex  
RM11 1EG*

*Linda Smith  
Finance Manager  
01827 72 6570*

---

Roadways Container Logistics Ltd.

Registered Office: Capital Gate, 320 New North Road, Hainault, IG6 3ES; registered in England and Wales with Company Number 46913. VAT No 942 5784 94.

This email has been scanned by the MessageLabs Email Security System.

---

## Steve Bromley

---

**From:** CL Pettet [chrissie.pettet@virginmedia.com]  
**Sent:** 26 February 2011 15:17  
**To:** Steve Bromley  
**Subject:** 77 Park Lane, Hornchurch.

Mrs Chrissie Pettet  
10 Hillcrest Road  
Hornchurch  
RM11 1EB

Dear Steve Bromley

It has come to my notice that the off Licence on Park Lane has requested an extended sale of alcohol licence ONCE AGAIN after 8pm at night.

I am totally against this as we have just got our street back to how it used to be, thanks to the local police team, Hylands SNT. Already I have witnessed an increase of anti social behaviour centred around the shop. We are now experiencing noise nuisance up until 1am in the early hours of the morning which previously had subsided substantially.

I excepted the fact that the shop would sell alcohol and had no qualms regarding the licence being up until 8pm but feel that an extension would draw more trouble and we would be back to square one ONCE AGAIN.

Please keep me informed of any updates on this matter.

Many Thanks

Mrs Chrissie Pettet

## Steve Bromley

---

**From:** Naomi Stephens [stephens.naomi@googlemail.com]  
**Sent:** 25 February 2011 22:11  
**To:** Steve Bromley  
**Subject:** 77 Park Lane

Dear Steve,

I'm writing yet again to object to the application to extend opening hours at 77 Park Lane.

Already the days are lengthening and youths are starting to hang about on street corners causing a public nuisance. Having an off-licence open later may encourage these youngsters to try and under-age drink and so to protect them from harm I believe this application should be refused.

Also being so close to Romford the surrounding areas often experience late night revellers making their way home having an off-licence open later will encourage these drunkards to drink again in the street causing noise, disruption and possibly crime.

We want our neighbourhood to be kept as safe as possible and I believe that extending these opening hours will not.

Regards

Naomi Stephens  
116 Clydesdale Road

## Steve Bromley

---

**From:** Alison Harman [alison.harman@btconnect.com]  
**Sent:** 24 February 2011 16:37  
**To:** Steve Bromley  
**Subject:** application for licence at 77 park lane hornchurch

hi steve

it has been brought to my notice that the park lane food centre has requested an extended licence until 11pm, during the week and midnight on saturdays.

myself and my family live in hillcrest rd, and although a quiet street during the day, we have started to see more groups of youths in our street at night, ( worse during the summer), i am concerned that a late licence will draw more people to this area causing a nuisance, with possible increases in crime, if there is no where else to go and purchase alcohol we will end up with a large problem in our area.

the purchase of alcohol normally means an increase in all sorts of nuisance nearby and as i myself have 2 young children ( 14 and 11), i am concerned about their safety.

there is a park nearby, and epecially during the summer, we see groups of youths taking alcohol over to the park, this is intimidating for dog walkers and children who wish to play there.

i would therefore request that you do not grant this extended licence

my address is

32 hillcrest rd hornchurch essex RM11 1EB you may also reach me on this e mail or on 07891 947130

many thanks for your time.

Alison Harman  
Senior Mortgage Consultant  
01708 478127

Crowley Financial LTD are appointed representatives of Legal & General Partnership Services LTD  
Legal & General Partnership Services LTD is authorised & regulated by the Financial Services Authority and can be found on the FSA register ([www.fsa.gov.uk/register](http://www.fsa.gov.uk/register)) under reference 300792.

Legal & General Partnership Services LTD provides advise on mortgages and general insurance products for consumers based in the United Kingdom. Not all mortgages are regulated by the FSA.

Privacy & Confidentialilty Notice;

The information contained in this e mail is confidential and is intended for the addressee only. If you are not the intended recipient please notify [alison.harman@btconnect.com](mailto:alison.harman@btconnect.com) and then delete the e mail. Any dissemination, distribution or use of this e mail without our prior consent is strictly prohibited. Any personal opinions expressed in this e mail are those of the sender and should not be taken to represent the views of the Network.

## Steve Bromley

---

**From:** adey-katy@o2.co.uk  
**Sent:** 23 February 2011 20:55  
**To:** Steve Bromley  
**Subject:** OBJECTION TO EXTENSION OF LICENSING FOR 77 PARK LANE RM11 1BH

Dear Mr Bromley,

I would like to apologise for sending my previously incomplete email in error.

We wish to make an objection to the application for a licensing extension by Park Lane Food Centre, addressed at 77 Park Lane, RM11 1BH. We were unhappy with the original application for a licence to sell alcohol and were to a certain extent appreciative of the fact that the licence granted was only until 8pm.

However we feel that a licence extension to 11pm and midnight is certain to create more antisocial behaviour in our locality. We have already noticed groups of youths congregating outside the premises and even sitting on the wall of the adjoining veterinary practice, causing nuisance and intimidating local residents. We consider this behaviour loitering with intent.

We are concerned that this loitering will result in some local underage youths attempting to buy alcohol, as has already been the problem at the Red Rose Wine shop at the end of the Park Lane parade.

This surely is a matter of preventing crime and disorder in our area.

Were the licence to be extended, you are making an already apparent problem with some local youths worse and police resources will be stretched further.

To surmise we would suggest that refusing to grant this extended licence will help to solve a growing pattern of anti social behaviour on Park Lane.

Yours sincerely

Adrian and Katy Farrell  
(15 Park Crescent, RM11 1BJ)

## Steve Bromley

---

**From:** Angela Williams [angela@isclawyers.co.uk]  
**Sent:** 23 February 2011 15:57  
**To:** Steve Bromley  
**Subject:** FW:

---

**From:** Angela Williams  
**Sent:** 23 February 2011 15:26  
**To:** 'steve.bromley@haverling.gov.uk'  
**Subject:** FW:

Dear Mr Bromley

It has been brought to our attention that number 77 Park Lane has applied for a licence to extend it's opening hours to (Sunday-Thursday 8am-11pm and Friday-Saturday 8am-Midnight!) and we are writing to express our concern at this proposal.

Even without the extended licensing hour, groups of youths are already congregating outside of the address in question in large numbers. This is intimidating even for two adults who want to pass through them to use the shop, let alone the several families with young children who wish to do the same. This gathering is already causing a public nuisance, and with the longer daylight hours and school holidays approaching, allowing the shop to extend it's licensing hours will only exacerbate the problem. Furthermore, the existence of later opening hours will surely encourage these youngsters, who are under the legal age to drink, to try and buy alcohol from the premises, which could see the problem of a public nuisance turn into one of crime and public safety.

Figures released on the police.uk/crime website show that the level of crime and antisocial behaviour in this area is already above the average when compared with the rest of England and Wales. Allowing 77 Park Lane to stay open longer selling alcohol will surely only add to this figure, and we ask that the premises not be allowed to extend it's opening hours.

Yours Faithfully

Miss Williams and David Murphy of 102 Park Lane, Hornchurch

---

This email has been scanned by the MessageLabs Email Security System.  
For more information please visit <http://www.messagelabs.com/email>

---

## **Steve Bromley**

---

**From:** Jackie Cooper  
**Sent:** 28 February 2011 14:07  
**To:** Steve Bromley  
**Subject:** personal

Re: Application to Vary Licensed Premises 77 Park Lane

I would to express my concern about the proposed extension of licensing hours for the above premises. This small parade of shops is in a residential area, it is likely that extended hours for the purchase of alcohol will result in street drinking and disturbance to residents which would be a public nuisance and may threaten public safety.

Jackie Cooper

104 Clydesdale Road

## Steve Bromley

---

**From:** Councillor Frederick Thompson  
**Sent:** 10 March 2011 13:44  
**To:** Steve Bromley; Paul Campbell; Licensing  
**Cc:** Councillor Andrew Curtin; Councillor Wendy Brice Thompson  
**Subject:** Application Number 9981, 77 Park Lane

Dear Sirs,

With reference to the latest application for a premises Licence extension of the present permit for the supply of alcohol to close at 23:00 from Sunday to Thursday and to close at Midnight, 00:00, on Friday and Saturday for the premises at 77 Park Lane, I wish to object on the basis that the hours are excessive and run too late an hour. This is likely to increase the impact of public nuisance as it will most likely lead to the already inebriated being drawn to the vicinity and more stopping traffic in the vicinity with blaring music, door slamming etc. There are known issues with the existing off-license not far away that my constituents have mentioned from time to time.

The police are already overstretched late at night in Romford and Hornchurch Town Centres and I fear that this lessens the necessary protection of children from harm as under 18 year old teenagers will be more able to pressure this outlet into illegal sales. There is also an increased risk of young shoplifters at these later hours.

In view of the above I think that the license should not be extended at all.

Regards,

**Cllr. Frederick Thompson**

**Tel: 01708 747993**

**Cell: 07895 096 765**

Visit Havering Museum 19-21 High Street, Romford.

For details see <http://www.haveringmuseum.org.uk/>





**137 Park Lane  
Hornchurch  
Essex  
RM11 1EQ**

Date 4<sup>th</sup> March 2011

Mr. Steve Bromley  
London Borough of Havering  
Mercury House  
Mercury Gardens  
Romford  
RM1 3SL

Dear Sir

**RE: Reference the Application to Vary Licensed Premises 77 Park Lane**

Further to your letter dated 1st March 2011 I set out below some details relating to the above premises application:-

Public nuisance - already experienced with people returning home along Park Lane from the pubs etc., so additional alcohol being readily available to be purchased from these premises, 77 Park Lane, after leaving the pubs/clubs when closed, would prove a public nuisance at such a late hour to all the residents in close proximity with probable loud disorder.

The prevention of crime and disorder - The more alcohol is readily available after already having been celebrating, could lead to crime ie., damage of parked cars and to whatever was targeted, also to disorderly conduct in the street.

Public Safety - People would feel unsafe when passing congregated unruly groups.

I trust this is now acceptable in accordance with your request for support in respect of refusal to extend the licensing hours for the sale of alcohol at the above premises..



Mrs. M. Winfield.

## Steve Bromley

---

**From:** nixonfamily@o2.co.uk  
**Sent:** 28 February 2011 12:50  
**To:** Steve Bromley  
**Subject:** Application to vary licensed Premises - 77 Park Lane

Dear Sirs

I was slightly confused when I saw the above application, as I have already been purchasing alcohol from that store well after 8pm. So has this application been approved or are they breaking the terms of their existing license already?

I disapprove of such long licencing hours as we already have more gangs of youths hanging around this establishment and I find this disturbing. I feel if you approve this application it will cause disorder to the local area.

Please also investigate why they are currently allowed to sell alcohol outside of their current licensing hours if this is the case.

many thanks

S Nixon  
3 Park Crescent

## Steve Bromley

---

**From:** chris Miller [biker\_toff@live.co.uk]  
**Sent:** 25 February 2011 12:42  
**To:** Steve Bromley  
**Subject:** RE: APPLICATION TO VARY LICENCED PREMISES 77 PARK LANE

*Application to vary licensed premises – 77 Park Lane*

*I am writing to request that the council decline the application to extend a license to sell alcohol at 77 Park Lane.*

*I live at 95 Park Lane directly next to the shops. We already have problems of youths congregating in this area and particularly in the summertime they are often found drunk and disorderly and causing a public nuisance. We already have one off license on Park Lane whereby teenagers can be found either asking older teenagers to purchase alcohol for them or obtaining it themselves we really do not need another one open until 11.00pm and midnight.*

*There is also another off license at the end of park lane at the end of Albert Road which is licensed until late.*

*Please consider this application very carefully your residents are depending on you to make the right decision in keeping our neighbourhood as safe as possible.*

*Kind regards*

Christopher Miller

---

MR H PATEL AND MR C PATEL  
65 PARK LANE  
HORNCHURCH  
RM11 1BH

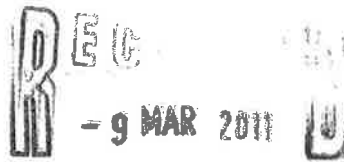

Tel :

8<sup>th</sup> MARCH 2011

To,  
Public Protection Manager  
Housing and Public Protection  
London Borough of Havering  
Mercury House  
Mercury Gardens  
Romford  
RM1 3SL

Dear Sirs,

**Re : Your Ref – SJB / 009981 – Premises Licence Application – 77 Park Lane, Hornchurch, Essex RM11 1BH**

Please accept this letter as an objection to the application referred above. We live within 50 metres or so of the premises.

The grounds for objection are:

**Potential poor control of the licence leading to increase in Crime and Disorder**

The retail sale of alcohol is a specialised business. There is already existing business for retail sale of alcohol within 50 metres or so and we have already experiencing late night noise and anti social behaviour. The premises already have a licence until 8pm and have created problems with youngsters coming in the area to purchase alcohol. On number of occasion police have come to resolve the problem with youngsters and shop owner. Our concern is that those refused alcohol in either well run supermarkets or public houses will seek to buy alcohol from the applicant. Most big licensees will not serve those that they know to be unfit. Our concern is that ready access to alcohol, when others have refused service or closed, will lead to anti-social behaviour. Due to suggested hours this is likely to attract those with drinking issues particularly at times when other outlets may not be available.

**Public Nuisance and Crime and Disorder due to localized consumption**

There are several locations within easy reach of this outlet that are likely to serve as natural places for those who purchase alcohol to consume it. Experience has shown that those who cannot 'enjoy' licensed premises will make use of such public places. In turn, this leads to public drunkenness, noise and litter. The availability of another outlet with extensive opening hours will make the situation significantly worse. This makes the whole area a haven for anti-social behaviour.

**Harm to Children**

This is residential area and children also live here. There is already a premise for the sale of alcohol. Further premise for the sale of alcohol until late night would be quite unacceptable and has the potential to have an adverse effect on morale and well being of local resident children.

**Increased traffic leading to Public Nuisance and reduced Public Safety**

Adding another premise to sell alcohol late into the night in the area means real threat to public safety and will cause more traffic noise and dangerous driving in a built-up residential area.

We would ask you to consider our concerns very carefully. As noted above, we are writing this letter as a local resident, with three young children. Should the application be granted, our family's quality of life will be affected, as will that of many local residents.

Yours faithfully



Mr H Patel



Mr C Patel

LONDON BOROUGH  
OF HAVERING  
MERCURY HOUSE  
ROMFORD

E. J. BURTON  
133 PARK WANE  
HORN CHURCH  
RM11 1EQ  
6-3-11

Dear Sir,

I am writing to yourself to ask that you consider turning down the application from Mrs. Sarker of 17 Park Lane, to extend their license to sell alcohol until 11pm in the week and to midnight on Fridays and Saturdays. They already have a license until 2pm to sell alcohol. If this extended license is granted, I am concerned that it will encourage more youths to congregate in the area. The selling of alcohol by the Park Lane Food Centre will, I fear, increase crime and nuisance fueled by alcohol sold to teenage drinkers. Sadly at a time when binge drinking is such a worry in communities around the country, the council should be considering the impact that this extension will have on the local area. I am convinced that the extending of this alcohol license will impact greatly on an increase in crime and public nuisance and disorder, particularly around the Park Lane shops and Park area, and the adjacent flats and old peoples complex in Park Lane.

We as a community should be doing our utmost to protect our children from the temptation of under age drinking, and the availability of alcohol through these types of outlets, could well compromise public safety and well being. Many thanks for your help in this matter.

Yours Sincerely  
J. B. [Signature]



## Steve Bromley

---

**From:** dawnatkins@supanet.com  
**Sent:** 10 March 2011 19:02  
**To:** Steve Bromley  
**Subject:** APPLICATION TO VARY LICENSED PREMISES AT 77 PARK LANE

In reply to you e-mail I am again sending my e-mail with my address attached.

I am writing to voice my concerns regarding the above application to vary licensing hours for the above premises. I strongly request that this application be refused for the following reasons.

Our worst fears, which were voiced at the last hearing, have been realised. Anti-social behaviour has increased with a large number of youths hanging around outside the premises drinking, smoking and urinating. On Friday 6th March Hyland PCSO's attended outside the shop where 25 youths were drinking, smoking and running amok. The owner of the store was seen outside talking to the youths, which obviously will not deter the behaviour. We do not get youths gathering outside Rose Wines, the other licensed outlet on the parade.

I believe that alcohol has been sold from the premises past 8pm, the hours that were agreed at the last hearing, so what is to say that if they are granted a license to trade until late that they will not sell after these hours!

As the summer months will soon be upon us the situation will get much worse, causing sleep deprivation and increased fears for residents safety and well-being. I do not wish for our community to have to suffer, as we did for a few years, by more alcohol being introduced into the area which will once again exacerbate the increase in anti-social behaviour. Also, with all the government cut backs can the Licensing Authority guarantee to the residents that there will be enough Police available to protect us against anti-social behaviour and keep us safe, if this variation to the license is granted.

Regards

Mrs S D Atkins  
8 Hillcrest Road  
Hornchurch  
RM11 1EB

-----  
Planet Ink Club is a great way to save money and help the environment.  
Join today (<http://www.planetinkclub.com>)

This message has been scanned by Supanet for viruses and dangerous content using ClamAV and SpamAssassin.

-----  
Planet Ink Club is a great way to save money and help the environment.  
Join today (<http://www.planetinkclub.com>)

This message has been scanned by Supanet for viruses and dangerous content using ClamAV and SpamAssassin.

-----  
Planet Ink Club is a great way to save money and help the environment.

## Steve Bromley

---

**From:** WHITEHEAD LORRAINE [lorraine.whitehead7@ntlworld.com]  
**Sent:** 10 March 2011 16:11  
**To:** Steve Bromley  
**Subject:** Re: Representation

Mrs & Mrs Whitehead  
150 Park Lane  
Hornchurch  
Essex  
RM11 1EG

Dear Mr Bromley

I am writing to ask that the application for the above premises to extend their hours to sell alcohol is refused again aswell in the future should any new applications be made.

Local residents and I wrote to yourself to express our concerns, attended both meetings at the Town Hall and helped to submit a petiton against late opening hours. I feel as this is a residential area our views have not changed since the license was granted until 8pm. As you are aware the issue of public nuisance with large groups of teenagers hanging around, causing damage to cars and properties, throwing litter and food, intimidating local people is still a problem in this area. Parking and traffic flow is also a problem for local residents. We are already woken late at night by youths shouting and swearing after drinkng in Romford and surrounding areas.

I have been approached by youngsters to buy cigarettes from this shop and would like to know if any spot checks have been done for underage purchases and alcohol being sold after 8pm.

As stated in our previous meetings the other office license closes early having experienced trouble in the last few years and following talks with the local police.

Kind regards  
Mr & Mrs Whitehead

On 10 March 2011 13:10, Steve Bromley <[Steve.Bromley@havering.gov.uk](mailto:Steve.Bromley@havering.gov.uk)> wrote:

Dear Mr&Mrs Whitehead

Thank you for your representation against the application for extended hours at 77 Park Lane, Hornchurch. Please can you re-submit your representation with your home address shown at the start of the representation.

Yours faithfully

Steve Bromley

**128 Park Lane  
Hornchurch  
Essex  
RM11 1BE**

8<sup>th</sup> March, 2011

Mr S Bromley  
Licensing Officer  
London Borough of Havering  
Mercury House  
Mercury Gardens  
Romford  
RM1 3SL

Your Reference: SJB/009981

Dear Sir

Licensing Act 2003  
Variation of a Premises Licence Application  
77 Park Lane, Hornchurch, Essex, RM11 1BH

I am writing to request that the above application be refused.

As I stated when opposing the original application, this neighbourhood has been prone to late night noise and disruption, especially the disorderly behaviour of drinkers passing through the area and the situation would not be improved by the late night selling of alcohol.

I have no reason to change my view.

Yours faithfully



John Marston

Housing & Public Protection  
FAO: Mr Steve Bromley  
London Borough of Havering  
Mercury House, Mercury Gardens  
Romford  
RM1 3SL

Mr James & Mrs Tracey Allan  
114 Park Lane  
Hornchurch  
Essex  
RM11 1BE  
Tel: 01708 765 449

Date: 07 March 2011

Your reference: SJB/009981

Dear Mr Bromley,

Licensing Act 2003  
Variation of a Premises Licence Application  
Park Lane Food Centre, 77 Park Lane, Hornchurch RM11 1BH

It is with reference to the above listed application that we are writing to inform you that we wish to oppose this license variation.

As we do live in such close proximity of this 'Food Centre' we feel well enabled to comment on it's activity and reasons as to why extended hours should be denied.

#### The prevention of crime and disorder

During the original council meeting concerning the granting of this alcohol license, many of our reasons may have been disregarded as 'not being in relation to this shops activity'. However, now we can actually state that there is an increased number of youths on a daily basis hanging around outside this shop and generally making a nuisance of themselves. We have witnessed objects been thrown around, swearing, spitting and urinating against other shop fronts. This is not just passing trade as they hang around this shop and go in and out frequently over the course of the evening.

On one occasion, I (Mrs Allan) was walking past with my neighbour and was verbally abused which on a dark evening is very intimidating.

On various occasions, we believe that alcohol has been sold after the designated license time of 8pm e.g. shortly before 11pm, Friday 4<sup>th</sup> March 2011 was the most recent. The shapes inside the bags, which have been changed to black (to hide the evidence we suspect), look suspiciously like alcohol and cans of beer but short of stopping customers and asking them what they have just purchased, we are unable to provide evidence but feel this is something that should be looked into further before even comprehending a license variation. After all, if the rules are being broken now, why would they then be abided by if later one was granted? Would it be pushed later and later?

#### The prevention of public nuisance

The aim of this shop was to provide a convenience to the local community but all it has created thus far is the increased number of youths and noise which is becoming unacceptable. We have lost count of the number of times we have been woken by shouting and swearing, we rush to look outside in case youths are vandalising or causing damage to property which has happened in the past. This is starting to affect our sleep and why should we as home owners suffer simply because of the sale of alcohol?

The owner may claim that the 8pm restriction is affecting his business but if he is there to serve the community then surely the 'Food Centre' is what is needed and not the off licence.

Perhaps his business is being affected due to the fact that there is already a number of off licenses, including Tesco, within a very short distance and it has absolutely nothing to do with the time of his license? Bearing in mind that Tesco is only allowed to trade until 10pm due to close proximity to residential lettings, why should a smaller run business within even closer proximity to residential lettings be granted such an extension?

#### Public Safety

As already mentioned, youths have already been verbally abusive. We didn't dare make a response to them but just kept walking. We felt too scared to enter our properties for fear that if they knew where we lived, there would be repercussions so we had to wait until they moved on. This is not the way we should be forced to live.

#### The protection of children from harm

The residents within close proximity of this shop are mainly made up of those with young families and we do not want our children growing up with the threat of bearing verbally abused/bullied simply for living opposite a parade of shops – what used to be a quite parade of shops.

As mentioned, the noise from youths outside this shop has already woken us up on more than one occasion, including our young family. This is very distressing for all of us. Why should they be subjected to this just so someone can make a few extra pounds on the sale of alcohol? Surely the shop should be wanting to integrate itself within the community and wanting to make its profit on the service that its name suggests ie Food Centre? Should this noise continue, we will be forced to make more calls to the local police thus making a drain on their services.

This is a busy thoroughfare for young school goers and the fact that youths are urinating in the street whilst hanging around outside this shop, makes it a very unpleasant path for them to travel.

Also, as per our 'suspicions' that alcohol is being sold after 8pm, can we dare suggest that alcohol may be being sold to those under-age? We are not implying that the license holder has but ask that it is investigated to rule out the possibility.

Your sincerely,

Mr & Mrs Allan

## Steve Bromley

---

**From:** MI SMITH [joanmel@btinternet.com]  
**Sent:** 11 March 2011 14:00  
**To:** Steve Bromley

Mr & Mrs Smith  
217 Park Lane, Hornchurch  
Ref SJB/070023

Dear Sir,

Re: 77 Park Lane, Hornchurch

We wish to reiterate that we oppose the application for the extended license of the above-mentioned property.

We fail to understand the need for these premises to sell alcohol so late in the evening. This would encourage young people to purchase alcohol until 12.00 o'clock which could lead to children being in danger of harm from the sale of alcohol to underage persons .

We have on numerous occasions had crowds of young people drinking in the park in Park Lane late at night, if there is a readily available alcohol sold so late at night this adds to the possibility of crime & disorder plus a public nuisance in the park which is hard to police.

We hope that the above just enlightens a small number of concerns that we have if this application is considered.

Yours sincerely,

Mr & Mrs Smith



Illustration © 2008, All Rights Reserved. All Rights Reserved



MR + MRS. BENNETT  
56, HILLCREST ROAD  
HORNCHURCH  
SUSSEX RM 11 1EB  
02 MAR 26 2011  
RECEIVED  
FEBRUARY 2011

TO HOUSING AND PUBLIC  
PROTECTION  
FAO MR. STEVE BROMLEY

RE: APPLICATION TO VARY LICENSED  
PREMISES 77, PARK LANE

WE ARE WRITING IN CONNECTION  
WITH THE ABOVE PREMISES WISHING TO  
EXTEND THEIR LICENSING HOURS. WE DO  
NOT WISH FOR THEIR APPLICATION TO BE  
GRANTED, AS THERE ARE ENOUGH PROBLEMS  
WITH GROUPS OF YOUTHS IN THE AREA NOW;  
WE ARE WORRIED FOR OUR SAFETY AND  
ALSO FOR OUR PROPERTY.

WE ASK FOR THE APPLICATION TO BE  
TURNED DOWN AS THERE IS ALREADY TOO  
MUCH ACCESSIBILITY TO ALCOHOL.

REGARDS

MRS. ERICA BENNETT  
MR. JAMES BENNETT

Mr. J. Downs.  
57 Hillcrest Rd.  
Hornchurch  
Essex.

RM11 1EF

02/02/11

Mr. Steve Bromley  
Housing & Public Protection  
London Boro' Havering  
Mercury House  
Mercury Gardens  
Romford RM1 3SL

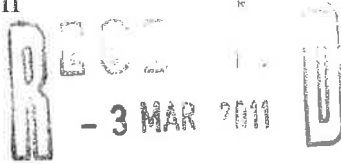

Dear Mr. Bromley.

With reference to the premises at 77 Park Lane Hornchurch.

I see that the occupiers of that premises have applied to extend their licensing hours to 8am – 11pm on Sunday to Thursday & 8am to Midnight on Saturday.

I wish to strongly object to this extension being granted. There are already many premises in the close area that sell alcohol during these times, we do not need any more. This is a residential area with a number of schools nearby. There are already an increased number of youngsters gathering in that area, we do not need another reason to give them a focal point. I think that in the current climate of distaste for youths imbibing alcohol, with the resulting disturbance, mess and antisocial behaviour that results from this; also with the governments policy of trying to reduce the current over consumption of alcohol, to grant this extension would be a mistake. There is already a problem with youths drinking alcohol in the parks nearby and also walking along our roads making a mess and a nuisance with noise, there has also been some damage to vehicles. Allowing another outlet for alcohol evenings and weekends will increase this nuisance.

We do not want this in our reasonably quiet residential area, which not only holds many elderly people, but also many young children.

Yours faithfully,

J. Downs.



1 Hillcrest Road  
Hornchurch  
Essex  
RM11 1EF

Licensing Committee / Sub Committee  
Committee Administration  
London Borough of Havering  
Town Hall Main Road  
Romford  
RM1 3BD

*By Fax: 01708 432424*

Dear Sirs

**Re: Park Lane Food Centre, 77 Park Lane, Hornchurch, RM11 1BH**

I write to formally object to the application in respect of the above premises.

Firstly, I wish to repeat the same objections that I raised in writing and subsequently at the application hearing that was heard on the 9<sup>th</sup> November 2010.

Since that hearing it has become apparent that there have been increased noise levels with a collection of a number of young people near the food centre on some evenings. I believe that this would potentially increase the risk of disorder, public safety and public nuisance.

I do not see the basis on which the applicant should be entitled to succeed and indeed this clearly incidents which supports concerns about allowing the grant of a license in the first place.

Yours faithfully



Michael Murphy

## Steve Bromley

---

**From:** Ted Street [ted.street@hotmail.co.uk]  
**Sent:** 10 March 2011 11:18  
**To:** Steve Bromley  
**Subject:** Application to vary Licensed Premises at 77 Park Lane, Hornchurch, Essex RM11 1BH

Dear Sir.

We would strongly oppose the above application on the grounds that:

1. The area is a residential one with young children and older people and we are concerned for their safety.
2. In Hillcrest Road we already suffer, particularly in the summer, from gatherings of younger people dropping cans and bottles on their way to Hylands Parfk where they cause considerable nuisance and litter. This has been mentioned to Community Police Officers who have informed us that they are monitoring the situation.
3. We already have an off licence some 50 yards from the above premises.

For the above reasons we strongly oppose the above application.

Mr. & Mrs. E.D. Street  
61 Hillcrest Road  
Hornchurch  
Essex RM11 1EF



## Steve Bromley

---

**From:** Ted Street [ted.street@hotmail.co.uk]  
**Sent:** 10 March 2011 11:18  
**To:** Steve Bromley  
**Subject:** Application to vary Licensed Premises at 77 Park Lane, Hornchurch, Essex RM11 1BH

Dear Sir,

We would strongly oppose the above application on the grounds that:

1. The area is a residential one with young children and older people and we are concerned for their safety.
2. In Hillcrest Road we already suffer, particularly in the summer, from gatherings of younger people dropping cans and bottles on their way to Hylands Park where they cause considerable nuisance and litter. This has been mentioned to Community Police Officers who have informed us that they are monitoring the situation.
3. We already have an off licence some 50 yards from the above premises.

For the above reasons we strongly oppose the above application.



Mr. & Mrs. L.J. Cook,  
65 Hillcrest Road  
Hornchurch  
Essex RM11 1EF

**From:** Carol Wilson [mailto:Carol.Wilson@barkingdagenhamcollege.ac.uk]  
**Sent:** 03 March 2011 14:46  
**To:** Steve Bromley  
**Subject:** Application tp vary licensed premises at 77 Park Lane

Dear Mr Bromley

I wish to register my concern in respect of the above application.

I am a resident at 100 Clydesdale Road.

We have previously had the police monitoring the area due to alcohol etc being sold in the parade of shops thereby causing a public nuisance/disturbance due to groups of youths congregating at the top of Clydesdale Road

In the past cars have been vandalised in respect of damaged wing mirrors or paint sprayed on residents' cars parked along Clydesdale Road.

Should alcohol be required there are a number of public houses/bars within the vicinity of Romford and Hornchurch which are open late thereby not needing alcohol to be available this late at night in a residential area.

If alcohol is purchased from 77 Park Lane late at night the likelihood is that is will be drunk in the vicinity of Park Lane and Clydesdale Road which is more than likely going to end up causing a public nuisance/disturbance and for this reason I wish to object to the application.

Thank you

**Carol Wilson**  
**D/Line 01708 770081**

C

## Steve Bromley

---

**From:** Graham Stone [graham@wobbly.plus.com]  
**Sent:** 05 March 2011 17:34  
**To:** Steve Bromley  
**Subject:** Application to vary licensed premises 77 Park Lane

Mr Bromley,

I understand that an application has been made to extend the licensed premises hours to 77 Park Lane Hornchurch.

I would like to raise an objection to this on the following grounds:

- \* Extended licensed opening hours will attract people to the area seeking alcohol which will increase crime and disorder in the area.
- \* Groups of young people tend to congregate where alcohol is sold and often public disturbance goes with this.
- \* With the Hylands Park and the park in Park Lane just a short distance away, another alcohol outlet will increase the use of these areas for drinking alcohol and causing public nuisance.
- \* The area has several young families living nearby and I feel that the area will be less pleasant and safe with the availability of alcohol over longer hours. The noise from people congregating late at night to buy alcohol will disturb sleeping children and make them feel unsafe.
- \* The off license is only a short walk from Romford town centre and persons may see this as a nearby location to obtain alcohol either on their way to or from the Romford nightlife.

I trust that you bear these matters in mind when considering the application. I look forward to hearing from you.

Yours sincerely,

Graham K Stone

14 Hillcrest Road  
Hornchurch  
Essex RM11 1EB

From: Miss G Brooks & Mr S Price  
116 Park Lane  
Hornchurch  
RM11 1BE

27th February 2011

Re: Variation of a Premises Licence Application, Park Lane Food Centre, 77 Park Lane.

Dear Sirs,

We are writing to you with regards to the above premises and ask strongly that the times of the licence are not extended. And since the last hearing have kept a log of incidents regarding number 77.

The Objectives

**The Prevention of Crime and Disorder**

We already have an Off Licence (Rose Wines ) on this parade that shuts around 9pm, this is due to the fact that past behaviour has shown that a large number of youths congregate in this area and if 77 is granted an extension open consistently late every night it will add to the problem of there already being the youths hanging about/ buying/ trying to buy alcohol numerous nights of the week at this premises (77 Park Lane). This problem has increased since the opening of number 77 and do not want it to be more of a problem than it already is. In the past this has caused crime and disorder and the residential neighbourhood has worked hard to keep this area free from disorder, we do not want this statistic in this part of Havering to rise.

Past behaviour is a good indicator of future behaviour and habits. In the past we have endured 3 incidents of having our car damaged due to youths hanging around late at night in the parade of shops and feel the later licence will attract more crime and disorder, making people behave anti socially around our property and immediate area.

**Public Safety**

We do not want people gathering around this area buying drinks

then heading over into local parks and then Romford making the area unsafe perhaps being approached by someone under the influence of alcohol late at night it's unsafe. Many arguments, stabbings, robberies etc are committed when intoxicated and we do not want to promote that kind of culture within our vicinity.

### **The Prevention Of Public Nuisance**

As a new business to the area you would like to try to support this premises and we did not appeal since the last hearing as we were prepared to give the shop a chance. But sadly I feel this can not be done. I am not a police officer, nor do I have the equipment to investigate, but living directly opposite I feel that this premises is already serving after 8pm and perhaps to those under the age of 18 and is not proving themselves to be in the interest of the residential community or managing appropriately.

Ok so the premises may have a suffering in business but surely that proves the only business being sold is that of the alcohol and sales of tobacco to youths not food, hence the name of 'Food Centre' is misleading and not serving or meeting the needs of this residential area and I feel not adhering to guidelines does not provide confidence in the premises or its behaviour in the future if this could be happening now. I feel this because of the following.....

**For example, Fri 14th Jan 2011,** 15 youths boys and girls, making nuisance behaviour, shouting loudly, screaming in the street, drinking outside the shop ( 77), moving signs then both the owner and his wife look directly over. Already noted the same evening two youths urinating up shop fronts of the parade after leaving the ' food centre'. This walk way is used daily by residents and young children walking to school and could attract vermin.

Surely this extension being applied for in the wife's (Mrs. Supkar) name again shows something isn't right, wasn't that one of the terms that it was in husband's name and wasn't it stated he is a 'responsible licence holder' in the report from the hearing?. He doesn't seem to be showing that, neither of them do.

### **Fri 11th Feb 2011**

20 youths hanging around the shop, sitting on the wall of the

vets causing noise and disturbance and the shop owner getting friendly, that's not responsible behaviour of that of a supposed responsible license holder.

**Feb half term Tues 22nd -Fri 25th**, youths every night of the week. I walked passed and was shouted abuse at for using a mobile phone, when out of view the youths moved on and the owner walked up towards the park afterwards where the youths were heading. Was this to conceal the behaviour of irresponsible sales, covering his tracks perhaps??. I do not want to spend every night looking out the window at this type of irresponsible behavior and with the lighter weather the attraction for youths is getting greater especially when applying for this extended license before the change of the clocks and it only being a few months since the last outcome.

The youths hanging about are here more nights then they are not, although they are not noisy every night it is still hard for us to relax, you never know what they are going to do, because you never know if they will cause damage to property or vehicles as some nights they're extremely noisy which is most weekends.

My partner and I both work long hours and already this is disturbing our sleep patterns, this would give us added stress, sleep deprivation eventually harm our health and general well being. There are several young families living opposite the parade and this extension would most defiantly disturb our sleep patterns, well it already is.

In the document from the details of the hearing it states " In reply to concerns raised by objectors, the applicant representatives stated that none of the issues raised could be linked directly to the premises, that these problems already existed, and his clients application would not be adding to it".

Sadly that's not the case he is adding to it, it is happening and it can only get worse.

### **The protection of children from harm**

I feel that the increase in young people hanging around this premises most evening shows that they are trying to purchase



alcohol/ cigarettes, why else would they? it's not for the lovely view or the weather something is attracting them and is that the purchase of intoxicating products, not sweets or crisps as I don't see any youths hanging around the news agents in the same parade every evening.

Youths swearing and shouting is not the environment we want our young daughter or ourselves to be subjected too as we can guarantee that there will continue to be youths hanging about, it's an ideal area for them to gather as they can get alcohol, food and a park within 100 yards, we want to nip the problems in the bud before they'll get worse.

Kind Regards  
G Brooks & S Price

## **Responsible authority representation**



Working together for a safer London

**The Licensing Authority  
London Borough of Havering  
Mercury House, Mercury Gardens,  
Romford, Essex  
RM1 3SL**

**Your Reference:**

**Our Reference:**

**Dave Leonard PC231KD  
Romford Police Station  
19 Main Road  
Romford,  
Essex  
RM1 3BJ**

**Telephone: 01708 432781  
Fax: 01708 432554**

**Email:  
haveringpolice@met.police.uk  
Dave.Leonard@met.police.uk  
Date: 10<sup>th</sup> March 2011**

Dear Sir,

**Re- Application To Vary A Premises Licence  
Park Lane Food Centre, 77 Park Lane, Hornchurch RM11 1BH**

With reference to the above, the Police *wish to make representation* against the application received on 22nd February 2011 to vary a premises licence registered by Ms Hatice Sapkur.

***The applicant has not satisfactorily addressed the additional steps they intend to take to prevent noise nuisance and anti-social behaviour if granted extended hours to supply alcohol in a predominantly residential location. This in turn is likely to lead to further crime & disorder and public nuisance issues arising.***

Local Safer Neighbourhood Teams, Romford Town Centre & Hylands Wards, are often tasked to deal with anti-social behaviour & disorder issues caused by youths who have acquired alcohol. It must be pointed out that the current trends don't necessarily always point to irresponsible sales. There is just as much concern that they are obtaining alcohol by ulterior means, be it by theft or by proxy sales made by irresponsible adults or older looking group members.

**Observations and Recommendations**

As a late-night convenience store situated in a modest shopping parade in a predominantly residential location, the premises is always likely to be associated with anti-social behaviour the later that it is open. It is very difficult to support an application wishing to conduct licensable activity past 11pm in a built-up residential location. There are very few off-licensed premises in Havering that have this facility and, even then, some cannot trade in accordance with these hours due to planning permission. As identified in the previous application, the nearest example of this is Tesco Roneo Corner which trades to 10pm.

As disclosed at the Licensing SubCommittee hearing on 9th November 2010, there are two local parks, Hylands and Maygreen, nearby. This automatically lends the premises to being a potential source for young people to obtain alcohol to consume in the parks. It is imperative that robust measures are taken to ensure the responsible supply of *all* age restricted products in this vicinity. When granting the premises licence, it was agreed by the Committee and all parties concerned that a sustained period of trading with modest licensed hours may allow the applicant to build a positive business reputation to reassure those who were sceptical of his intent. The shop has not yet traded in the warmer, summer months where it remains lighter for longer.

I am aware that the LLA Licensing Officer, Steve Bromley, has previously caught out staff at the premises selling alcohol after their current licensable hours. I am also aware that the proprietor does not always enter into the community spirit with the local safer neighbourhood teams. ***This does not inspire the police to support the application with any level of confidence.***

We supported the Licensing Sub-Committee's decision at the last hearing & are not seeking any further conditions to be attached to premises licence. Police are mindful that there has been a lot of local resentment to this application & the Licensing Committee may wish to make reference to the following policies taken from the ***Statement of Licensing Policy 2010 [Appendix 9]***;

#### Licensing Policy 008

The LLA is committed to protecting the amenity of residents and businesses in the vicinity of licensed premises. Where relevant representations are received, the LLA may attach appropriate conditions to licences, necessary to support the prevention of undue noise disturbance from licensed premises.

#### Licensing Policy 12

The LLA is committed to protecting the amenity of residents and businesses in the vicinity of licensed premises. Applications for hours set out below in this policy will generally be granted subject to not being contrary to other policies in the statement of licensing policy. Applications for hours outside the hours listed will be considered on their merits.

Regulated activities will normally be permitted:

- until 11.30 pm in residential areas
- until 00.30 am in mixed use areas
- No limits in leisure areas.

#### Licensing Policy 013

The LLA supports the principle of flexibility in its approach to licensing hours and will consider the merits of each individual application. Nothing in this policy will oblige the holder of a premises licence or club premises certificate to remain open for the entire period permitted by the licence or certificate. The LLA will normally require all licensed premises to be cleared of patrons within a reasonable period after the end of the time permitted for licensable activities. Proposals for clearing the premises or a dispersal policy should be included in the detail of the operating schedule.

#### Licensing Policy 014

Where relevant representations are received from responsible authorities and/or interested parties, the LLA may seek to restrict the operational hours of premises where this is necessary to promote the licensing objectives. The LLA may impose further limitations in hours upon review of the licence, particularly where the premises is shown to be the focus or cause of nuisance or anti-social behaviour.

**Licensing Policy 015**

In considering applications for new licences or variations to existing licences and licence reviews following the receipt of relevant representations, the LLA will take the matters listed below into account. These criteria will apply in different ways to different types of premises and licensable activities in the following order:

- the location of the premises and character of the area
- the views of responsible authorities
- The views of interested parties
- past compliance history of current management
- the proposed hours of operation.

If I can be of any further assistance in this matter please do not hesitate to contact me in the Licensing Office at Mercury House on **01708 432781**.

Yours sincerely,



**Dave Leonard**  
**Licensing Officer**  
**Havering Borough Police**

**Representations supporting the application**

Date 24.02

Licensing London Borough of Havering,  
Public Protection,  
Mercury House,  
Mercury Gardens,  
Romford.  
RM1 3SL

Dear Sir / Madam,

**Application to Vary a Premises Licence for Park Lane Food centre, 77 Park Lane,  
Hornchurch RM11 1BH**

I wish to state that I fully support the application for an extension of the licensed hours for the premises licence for Park Lane Food Centre until 11.00 pm Sunday to Thursday and midnight Friday & Saturday.

I do not see any problems or undermining of the Licensing Objectives in permitting the extended licensed hours as it will be convenient to have the off licence available for longer hours. As the shop is open past the current permitted hours it makes sense to permit the longer licensed hours.

I have not witnessed or become aware of any anti social behaviour in the area or other criminality due to the opening of Park Lane Food Centre or following the shop obtaining a Licence.

Please feel free to contact me at the above address or on should you have any queries.

Yours faithfully,

  
MR MANN  
175 DAGENHAM RD  
LUSH GREEN  
ROMFORD  
RM7

W LAGDEN  
73 Brentwood  
ROAD Romford  
ESSEX  
RM1 2EU

Date; 15/10/2010

**London Borough of Havering Licence Team  
Public Protection  
Mercury House  
Mercury Gardens  
Romford  
RM1 3SL**

Dear Sirs,

**Re: Application for Premises licence, at Park Lane Food Centre, 77  
Park Lane Hornchurch RM11 1BH.**

I wish to advise you that I fully support the application for premises licence regarding the above mentioned premises.

I don't see any problem in a second off licence being made available to the public.

I would also wish to advise that I have not witnessed any anti social behaviour due to the off licence presently situated at Park Lane.

Should you have any further queries, please contact me on .....

Yours faithfully



30 Frazer  
4109e  
Romford  
Essex  
RM1 2DF

Date; 19/02/2010

London Borough of Havering Licence Team  
Public Protection  
Mercury House  
Mercury Gardens  
Romford  
RM1 3SL

Dear Sirs,

**Re: Application for Premises licence, at Park Lane Food Centre, 77  
Park Lane Hornchurch RM11 1BH.**

I wish to advise you that I fully support the application for premises licence regarding the above mentioned premises.

I don't see any problem in a second off licence being made available to the public.

I would also wish to advise that I have not witnessed any anti social behaviour due to the off licence presently situated at Park Lane

Should you have any further queries, please contact me on 

07952415623

Yours faithfully

M. Macdon  
14 ARANSANE RD,  
HORNECHURCH,  
ESSEX.

Date: 20/02/2011

London Borough of Havering Licence Team  
Public Protection  
Mercury House  
Mercury Gardens  
Romford  
RM1 3SL

Dear Sirs,

**Re: Application for Premises licence, at Park Lane Food Centre, 77  
Park Lane Hornchurch RM11 1BH.**

I wish to advise you that I fully support the application for premises licence regarding the above mentioned premises.

I don't see any problem in a second off licence being made available to the public.

I would also wish to advise that I have not witnessed any anti social behaviour due to the off licence presently situated at Park Lane.

Should you have any further queries, please contact me on 01708 733631

Yours faithfully

M. Macdon

3 FANETT  
52 MALVERN RD  
HORNCURCH  
RM11 1BQ

Date: 20/2/2011

London Borough of Havering Licence Team  
Public Protection  
Mercury House  
Mercury Gardens  
Romford  
RM1 3SL

Dear Sirs,

**Re: Application for Premises licence, at Park Lane Food Centre, 77  
Park Lane Hornchurch RM11 1BH.**

I wish to advise you that I fully support the application for premises licence regarding the above mentioned premises.

I don't see any problem in a second off licence being made available to the public.

I would also wish to advise that I have not witnessed any anti social behaviour due to the off licence presently situated at Park Lane.

Should you have any further queries, please contact me on .....

Yours faithfully

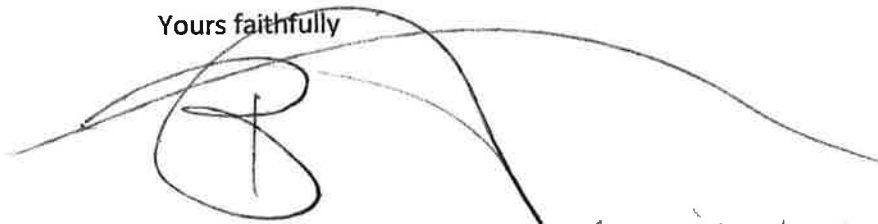

A VERY CONVENIENT STORE WHICH  
PROVIDES A VERY USEFUL COMMUNITY SERVICE.

LUKE ROGERS

73, HILLCREST ROAD,

HORNCHURCH,

ESSEX,

RM11 1EF

Date: 19/02/2010

London Borough of Havering Licence Team  
Public Protection  
Mercury House  
Mercury Gardens  
Romford  
RM1 3SL

Dear Sirs,

**Re: Application for Premises licence, at Park Lane Food Centre, 77  
Park Lane Hornchurch RM11 1BH.**

I wish to advise you that I fully support the application for premises licence regarding the above mentioned premises.

I don't see any problem in a second off licence being made available to the public.

I would also wish to advise that I have not witnessed any anti social behaviour due to the off licence presently situated at Park Lane.

Should you have any further queries, please contact me on 07996681408

Yours faithfully

I am happy for a later closure,  
as this will be of great convenience  
for the community.



22 Hillcrest Road  
Hornchurch  
Essex  
RM11 1EB

Date; 01/02/2010

**London Borough of Havering Licence Team  
Public Protection  
Mercury House  
Mercury Gardens  
Romford  
RM1 3SL**

Dear Sirs,

**Re: Application for Premises licence, at Park Lane Food Centre, 77  
Park Lane Hornchurch RM11 1BH.**

I wish to advise you that I fully support the application for premises licence regarding the above mentioned premises.

I don't see any problem in a second off licence being made available to the public.

I would also wish to advise that I have not witnessed any anti social behaviour due to the off licence presently situated at Park Lane.

Should you have any further queries, please contact me on .....

Yours faithfully

*Andrea Grottick*

Mark Their manny  
92 Park lane  
RM11 1BE  
.....  
.....

Date: 19/2/2010

London Borough of Havering Licence Team  
Public Protection  
Mercury House  
Mercury Gardens  
Romford  
RM1 3SL

Dear Sirs,

**Re: Application for Premises licence, at Park Lane Food Centre, 77  
Park Lane Hornchurch RM11 1BH.**

I wish to advise you that I fully support the application for premises licence regarding the above mentioned premises.

I don't see any problem in a second off licence being made available to the public.

I would also wish to advise that I have not witnessed any anti social behaviour due to the off licence presently situated at Park Lane.

Should you have any further queries, please contact me on 07904397120

Yours faithfully

Happy for Skoop to be open  
anytime a good help

M T 

Date 25/02/11

Licensing London Borough of Havering,  
Public Protection,  
Mercury House,  
Mercury Gardens,  
Romford.  
RM1 3SL

Dear Sir / Madam,

**Application to Vary a Premises Licence for Park Lane Food centre, 77 Park Lane, Hornchurch RM11 1BH**

I wish to state that I fully support the application for an extension of the licensed hours for the premises licence for Park Lane Food Centre until 11.00 pm Sunday to Thursday and midnight Friday & Saturday.

I do not see any problems or undermining of the Licensing Objectives in permitting the extended licensed hours as it will be convenient to have the off licence available for longer hours. As the shop is open past the current permitted hours it makes sense to permit the longer licensed hours.

I have not witnessed or become aware of any anti social behaviour in the area or other criminality due to the opening of Park Lane Food Centre or following the shop obtaining a Licence.

Please feel free to contact me at the above address or on should you have any queries.

Yours faithfully,

Mrs N. Banks  
40 Bush elms Road  
Hornchurch  
RM11 1LS

07956 353917

Date

29/2/11

Licensing London Borough of Havering,  
Public Protection,  
Mercury House,  
Mercury Gardens,  
Romford.  
RM1 3SL

Dear Sir / Madam,

**Application to Vary a Premises Licence for Park Lane Food centre, 77 Park Lane,  
Hornchurch RM11 1BH**

I wish to state that I fully support the application for an extension of the licensed hours for the premises licence for Park Lane Food Centre until 11.00 pm Sunday to Thursday and midnight Friday & Saturday.

I do not see any problems or undermining of the Licensing Objectives in permitting the extended licensed hours as it will be convenient to have the off licence available for longer hours. As the shop is open past the current permitted hours it makes sense to permit the longer licensed hours.

I have not witnessed or become aware of any anti social behaviour in the area or other criminality due to the opening of Park Lane Food Centre or following the shop obtaining a Licence.

Please feel free to contact me at the above address or on should you have any queries.

Yours faithfully,

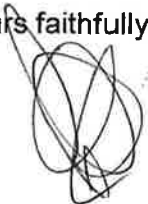

77 Park Lane  
Hornchurch  
RM11 1BH

Paul Massarella

01708 733 469



S. PAYNE  
73 PARK LANE  
HORNCHURCH  
ESSEX  
RM11 1BH

Date; 15./10./2010

London Borough of Havering Licence Team  
Public Protection  
Mercury House  
Mercury Gardens  
Romford  
RM1 3SL

Dear Sirs,

**Re: Application for Premises licence, at Park Lane Food Centre, 77  
Park Lane Hornchurch RM11 1BH.**

I wish to advise you that I fully support the application for premises licence regarding the above mentioned premises.

I don't see any problem in a second off licence being made available to the public.

I would also wish to advise that I have not witnessed any anti social behaviour due to the off licence presently situated at Park Lane.

Should you have any further queries, please contact me on .....

Yours faithfully

Date

25/2/11

Licensing London Borough of Havering,  
Public Protection,  
Mercury House,  
Mercury Gardens,  
Romford.  
RM1 3SL

Dear Sir / Madam,

**Application to Vary a Premises Licence for Park Lane Food centre, 77 Park Lane,  
Hornchurch RM11 1BH**

I wish to state that I fully support the application for an extension of the licensed hours for the premises licence for Park Lane Food Centre until 11.00 pm Sunday to Thursday and midnight Friday & Saturday.

I do not see any problems or undermining of the Licensing Objectives in permitting the extended licensed hours as it will be convenient to have the off licence available for longer hours. As the shop is open past the current permitted hours it makes sense to permit the longer licensed hours.

I have not witnessed or become aware of any anti social behaviour in the area or other criminality due to the opening of Park Lane Food Centre or following the shop obtaining a Licence.

Please feel free to contact me at the above address or on should you have any queries.

Yours faithfully,

(L. Fowler)

Lea Fowler

81 Park Lane

Hornchurch

Essex RM11 1BH.

I'm happy for this shop to open longer hours.

M LAGDEN  
73 BRENTWOOD RD  
ROMFORD  
ESSEX  
RM1 2EU

Date: 15/10/2010

London Borough of Havering Licence Team  
Public Protection  
Mercury House  
Mercury Gardens  
Romford  
RM1 3SL

Dear Sirs,

**Re: Application for Premises licence, at Park Lane Food Centre, 77  
Park Lane Hornchurch RM11 1BH.**

I wish to advise you that I fully support the application for premises licence regarding the above mentioned premises.

I don't see any problem in a second off licence being made available to the public.

I would also wish to advise that I have not witnessed any anti social behaviour due to the off licence presently situated at Park Lane.

Should you have any further queries, please contact me on .....

Yours faithfully

Date 25/2/11

Licensing London Borough of Havering,  
Public Protection,  
Mercury House,  
Mercury Gardens,  
Romford.  
RM1 3SL

Dear Sir / Madam,

**Application to Vary a Premises Licence for Park Lane Food centre, 77 Park Lane,  
Hornchurch RM11 1BH**

I wish to state that I fully support the application for an extension of the licensed hours for the premises licence for Park Lane Food Centre until 11.00 pm Sunday to Thursday and midnight Friday & Saturday.

I do not see any problems or undermining of the Licensing Objectives in permitting the extended licensed hours as it will be convenient to have the off licence available for longer hours. As the shop is open past the current permitted hours it makes sense to permit the longer licensed hours.

I have not witnessed or become aware of any anti social behaviour in the area or other criminality due to the opening of Park Lane Food Centre or following the shop obtaining a Licence.

Please feel free to contact me at the above address or on should you have any queries.

Yours faithfully,

Elther ADRIWORTH

3 Allandale Rd  
RM11 1AP

01708 741815

98 Clydesdale Rd  
Hornchurch  
Essex  
RM11 1AJ

Date; 21/02/2010

London Borough of Havering Licence Team  
Public Protection  
Mercury House  
Mercury Gardens  
Romford  
RM1 3SL

Dear Sirs,

**Re: Application for Premises licence, at Park Lane Food Centre, 77  
Park Lane Hornchurch RM11 1BH.**

I wish to advise you that I fully support the application for premises licence regarding the above mentioned premises.

I don't see any problem in a second off licence being made available to the public.

I would also wish to advise that I have not witnessed any anti social behaviour due to the off licence presently situated at Park Lane.

Should you have any further queries, please contact me on .....

Yours faithfully



Mr. D. Seedat

Date 24.02.

Licensing London Borough of Havering,  
Public Protection,  
Mercury House,  
Mercury Gardens,  
Romford.  
RM1 3SL

Dear Sir / Madam,

**Application to Vary a Premises Licence for Park Lane Food centre, 77 Park Lane,  
Hornchurch RM11 1BH**

I wish to state that I fully support the application for an extension of the licensed hours for the premises licence for Park Lane Food Centre until 11.00 pm Sunday to Thursday and midnight Friday & Saturday.

I do not see any problems or undermining of the Licensing Objectives in permitting the extended licensed hours as it will be convenient to have the off licence available for longer hours. As the shop is open past the current permitted hours it makes sense to permit the longer licensed hours.

I have not witnessed or become aware of any anti social behaviour in the area or other criminality due to the opening of Park Lane Food Centre or following the shop obtaining a Licence.

Please feel free to contact me at the above address or on should you have any queries.

Yours faithfully,

D. BRIDGE,

68 CLYDES DALE.

S CLAYDON  
151 PARK LANE  
HORNCHURCH  
ESSEX  
RM11 1BH

Date: 19/2/2010

London Borough of Havering Licence Team  
Public Protection  
Mercury House  
Mercury Gardens  
Romford  
RM1 3SL

Dear Sirs,

**Re: Application for Premises licence, at Park Lane Food Centre, 77  
Park Lane Hornchurch RM11 1BH.**

I wish to advise you that I fully support the application for premises licence regarding the above mentioned premises.

I don't see any problem in a second off licence being made available to the public.

I would also wish to advise that I have not witnessed any anti social behaviour due to the off licence presently situated at Park Lane.

Should you have any further queries, please contact me on .....

Yours faithfully

I AM HAPPY FOR THIS SHOP  
TO STAY OPEN LONGER HOURS

S. Clayton

98 Clydesdale Rd  
Hornchurch  
Essex  
RM11 1AS

Date; 21/02/2010

London Borough of Havering Licence Team  
Public Protection  
Mercury House  
Mercury Gardens  
Romford  
RM1 3SL

Dear Sirs,

**Re: Application for Premises licence, at Park Lane Food Centre, 77  
Park Lane Hornchurch RM11 1BH.**

I wish to advise you that I fully support the application for premises licence regarding the above mentioned premises.

I don't see any problem in a second off licence being made available to the public.

I would also wish to advise that I have not witnessed any anti social behaviour due to the off licence presently situated at Park Lane.

Should you have any further queries, please contact me on .....

Yours faithfully



Mrs. C. Seedat



GARY THOMSON  
50 MALVERN RD  
HORNCURCH  
RM11 1BQ

Date: 20/01/2010

London Borough of Havering Licence Team  
Public Protection  
Mercury House  
Mercury Gardens  
Romford  
RM1 3SL

Dear Sirs,

**Re: Application for Premises licence, at Park Lane Food Centre, 77  
Park Lane Hornchurch RM11 1BH.**

I wish to advise you that I fully support the application for premises licence regarding the above mentioned premises.

I don't see any problem in a second off licence being made available to the public.

I would also wish to advise that I have not witnessed any anti social behaviour due to the off licence presently situated at Park Lane.

Should you have any further queries, please contact me on 07779 702691

Yours faithfully



30 FRAZER CLOSE  
ROMFORD  
RM1 2NF

Date; 19/2/2010

London Borough of Havering Licence Team  
Public Protection  
Mercury House  
Mercury Gardens  
Romford  
RM1 3SL

Dear Sirs,

**Re: Application for Premises licence, at Park Lane Food Centre, 77  
Park Lane Hornchurch RM11 1BH.**

I wish to advise you that I fully support the application for premises licence regarding the above mentioned premises.

I don't see any problem in a second off licence being made available to the public.

I would also wish to advise that I have not witnessed any anti social behaviour due to the off licence presently situated at Park Lane.

Should you have any further queries, please contact me on 07751615718

Yours faithfully

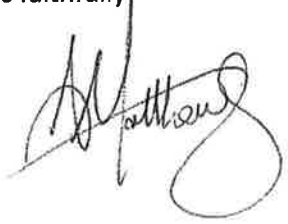

MRS TAYLOR  
43 MARLBOROUGH  
HORNBURCH  
RM11 1BG

Date; 19.02.2010

London Borough of Havering Licence Team  
Public Protection  
Mercury House  
Mercury Gardens  
Romford  
RM1 3SL

Dear Sirs,

**Re: Application for Premises licence, at Park Lane Food Centre, 77  
Park Lane Hornchurch RM11 1BH.**

I wish to advise you that I fully support the application for premises licence regarding the above mentioned premises.

I don't see any problem in a second off licence being made available to the public.

I would also wish to advise that I have not witnessed any anti social behaviour due to the off licence presently situated at Park Lane.

Should you have any further queries, please contact me on 07770282150

Yours faithfully



ARIAN Beguni  
21 A park lane  
RM11 3LH  
Hornchurch Romford  
Essex

Date: 20/01/2010

London Borough of Havering Licence Team  
Public Protection  
Mercury House  
Mercury Gardens  
Romford  
RM1 3SL

Dear Sirs,

**Re: Application for Premises licence, at Park Lane Food Centre, 77  
Park Lane Hornchurch RM11 1BH.**

I wish to advise you that I fully support the application for premises licence regarding the above mentioned premises.

I don't see any problem in a second off licence being made available to the public.

I would also wish to advise that I have not witnessed any anti social behaviour due to the off licence presently situated at Park Lane.

Should you have any further queries, please contact me on .....



Yours faithfully

I'm Happy for this shop to open late

J. Matchard  
87A Park  
Lane  
RM11 1BH

19/2/2011

Date; ...../...../2010

London Borough of Havering Licence Team  
Public Protection  
Mercury House  
Mercury Gardens  
Romford  
RM1 3SL

Dear Sirs,

**Re: Application for Premises licence, at Park Lane Food Centre, 77  
Park Lane Hornchurch RM11 1BH.**

I wish to advise you that I fully support the application for premises licence regarding the above mentioned premises.

I don't see any problem in a second off licence being made available to the public.

I would also wish to advise that I have not witnessed any anti social behaviour due to the off licence presently situated at Park Lane.

Should you have any further queries, please contact me on .....01708 732360

Yours faithfully

No problems. Happy for it  
to continue to extend  
licence.  
J. Matchard

ROGER MITCHELL  
6 BUSH CROFT RD  
HORNBURCH.....  
ESSEX CM8 3LJ  
.....

Date: 18/2/2010

London Borough of Havering Licence Team  
Public Protection  
Mercury House  
Mercury Gardens  
Romford  
RM1 3SL

Dear Sirs,

**Re: Application for Premises licence, at Park Lane Food Centre, 77  
Park Lane Hornchurch RM11 1BH.**

I wish to advise you that I fully support the application for premises licence regarding the above mentioned premises.

I don't see any problem in a second off licence being made available to the public.

I would also wish to advise that I have not witnessed any anti social behaviour due to the off licence presently situated at Park Lane.

Should you have any further queries, please contact me on 07902460018

Yours faithfully



Bradley  
Martins  
27 RUSH LIMS  
Road Hornchurch  
RM14 1EE

Date: 19/2/2010

London Borough of Havering Licence Team  
Public Protection  
Mercury House  
Mercury Gardens  
Romford  
RM1 3SL

Dear Sirs,

**Re: Application for Premises licence, at Park Lane Food Centre, 77  
Park Lane Hornchurch RM11 1BH.**

I wish to advise you that I fully support the application for premises licence regarding the above mentioned premises.

I don't see any problem in a second off licence being made available to the public.

I would also wish to advise that I have not witnessed any anti social behaviour due to the off licence presently situated at Park Lane.

Should you have any further queries, please contact me on 079506904101

Yours faithfully

I would like this off licence to be extended, for another hour because it is very convenient

Date 22-02-

Licensing London Borough of Havering,  
Public Protection,  
Mercury House,  
Mercury Gardens,  
Romford.  
RM1 3SL

Dear Sir / Madam,

**Application to Vary a Premises Licence for Park Lane Food centre, 77 Park Lane, Hornchurch RM11 1BH**

I wish to state that I fully support the application for an extension of the licensed hours for the premises licence for Park Lane Food Centre until 11.00 pm Sunday to Thursday and midnight Friday & Saturday.

I do not see any problems or undermining of the Licensing Objectives in permitting the extended licensed hours as it will be convenient to have the off licence available for longer hours. As the shop is open past the current permitted hours it makes sense to permit the longer licensed hours.

I have not witnessed or become aware of any anti social behaviour in the area or other criminality due to the opening of Park Lane Food Centre or following the shop obtaining a Licence.

Please feel free to contact me at the above address or on should you have any queries.

Yours faithfully,

L.M. Daw  
131, Douglas Rd.  
RM 11 1AW  
01708 735002.



Vaherise Muzeloya  
79A clydesdale RD  
Hornchurch  
RM11 1AJ  
Essex

Date: 19/07/2010

London Borough of Havering Licence Team  
Public Protection  
Mercury House  
Mercury Gardens  
Romford  
RM1 3SL

Dear Sirs,

**Re: Application for Premises licence, at Park Lane Food Centre, 77  
Park Lane Hornchurch RM11 1BH.**

I wish to advise you that I fully support the application for premises licence regarding the above mentioned premises.

I don't see any problem in a second off licence being made available to the public.

I would also wish to advise that I have not witnessed any anti social behaviour due to the off licence presently situated at Park Lane.

Should you have any further queries, please contact me on 01708736886

Yours faithfully

V. Muzeloya  
Happy to have them open till  
late. no problems

A. Pausley  
59 Park Lane  
RM11 1BH

Date: 19/2/2010

London Borough of Havering Licence Team  
Public Protection  
Mercury House  
Mercury Gardens  
Romford  
RM1 3SL

Dear Sirs,

**Re: Application for Premises licence, at Park Lane Food Centre, 77  
Park Lane Hornchurch RM11 1BH.**

I wish to advise you that I fully support the application for premises licence regarding the above mentioned premises.

I don't see any problem in a second off licence being made available to the public.

I would also wish to advise that I have not witnessed any anti social behaviour due to the off licence presently situated at Park Lane.

Should you have any further queries, please contact me on .....

Yours faithfully

I have no problem with this Beer  
in shop a good few times  
very Respectfull people

A. Pausley

MARK WEST  
67 Park Lane  
Hornchurch  
ESSEX  
RM11 1BH

Date; 16/2/2010

London Borough of Havering Licence Team  
Public Protection  
Mercury House  
Mercury Gardens  
Romford  
RM1 3SL

Dear Sirs,

**Re: Application for Premises licence, at Park Lane Food Centre, 77  
Park Lane Hornchurch RM11 1BH.**

I wish to advise you that I fully support the application for premises licence regarding the above mentioned premises.

I don't see any problem in a second off licence being made available to the public.

I would also wish to advise that I have not witnessed any anti social behaviour due to the off licence presently situated at Park Lane.

Should you have any further queries, please contact me on 07875738389

Yours faithfully

I'm happy for the owners of this shop to sell alcohol 7 days a week to 11pm, as myself I purchase on a regular basis and it would be convenient for myself to purchase alcohol to this extension.  
Thankyou Mark