

Upper Stand Level

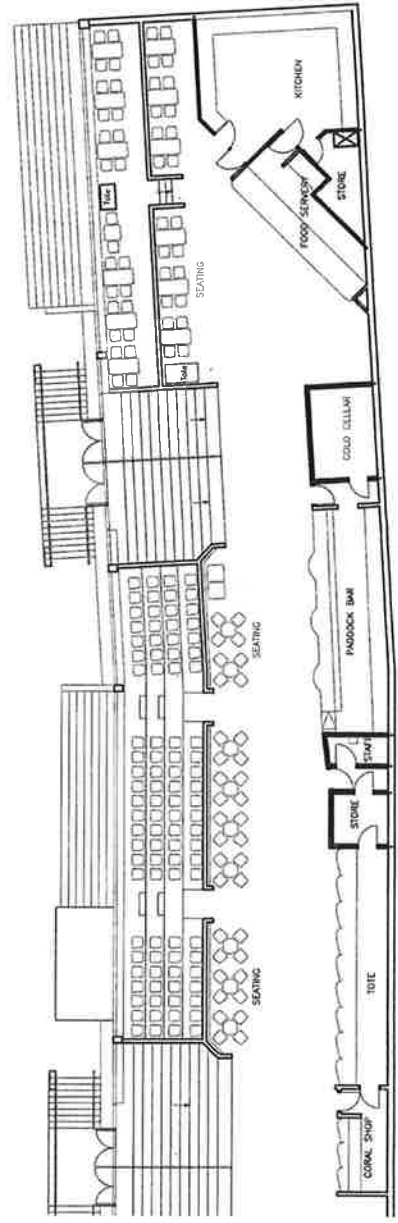

PIERCE HILL PROJECT SERVICES  
 Millennium Stand Upper Level  
 Romford Stadium Romford

P04-142:04 1:200

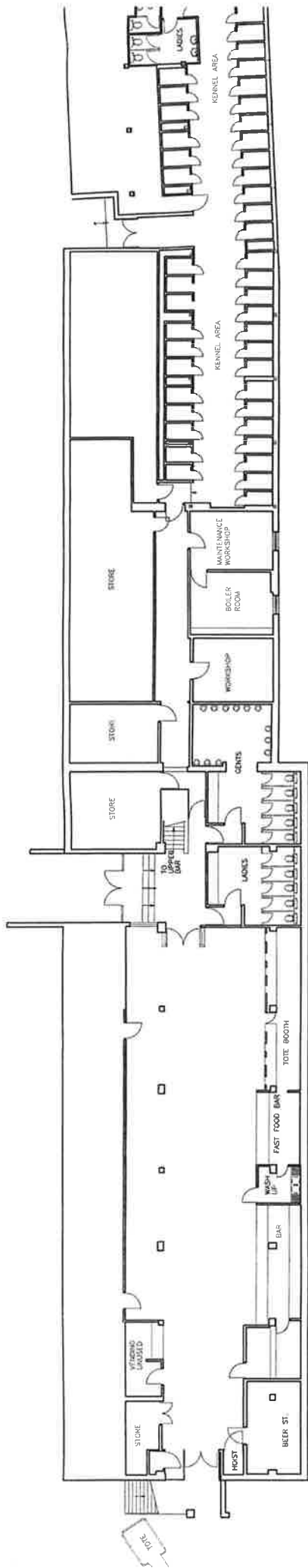

Lower (Ground) Level

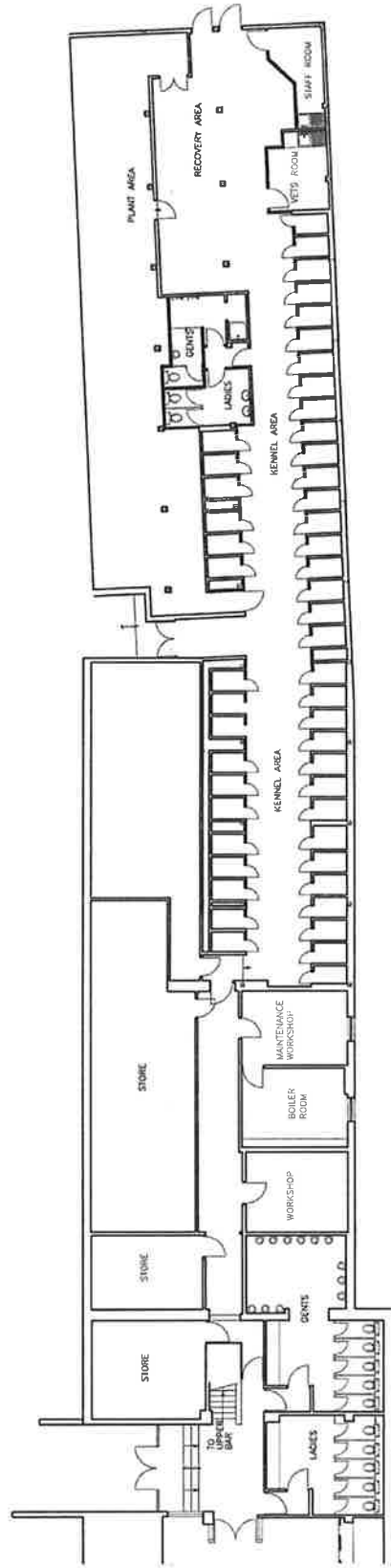

PIERCE HILL PROJECT SERVICES  
 Millennium Stand Lower (Ground) Level  
 Romford Stadium Romford

P04-142:03 1:200

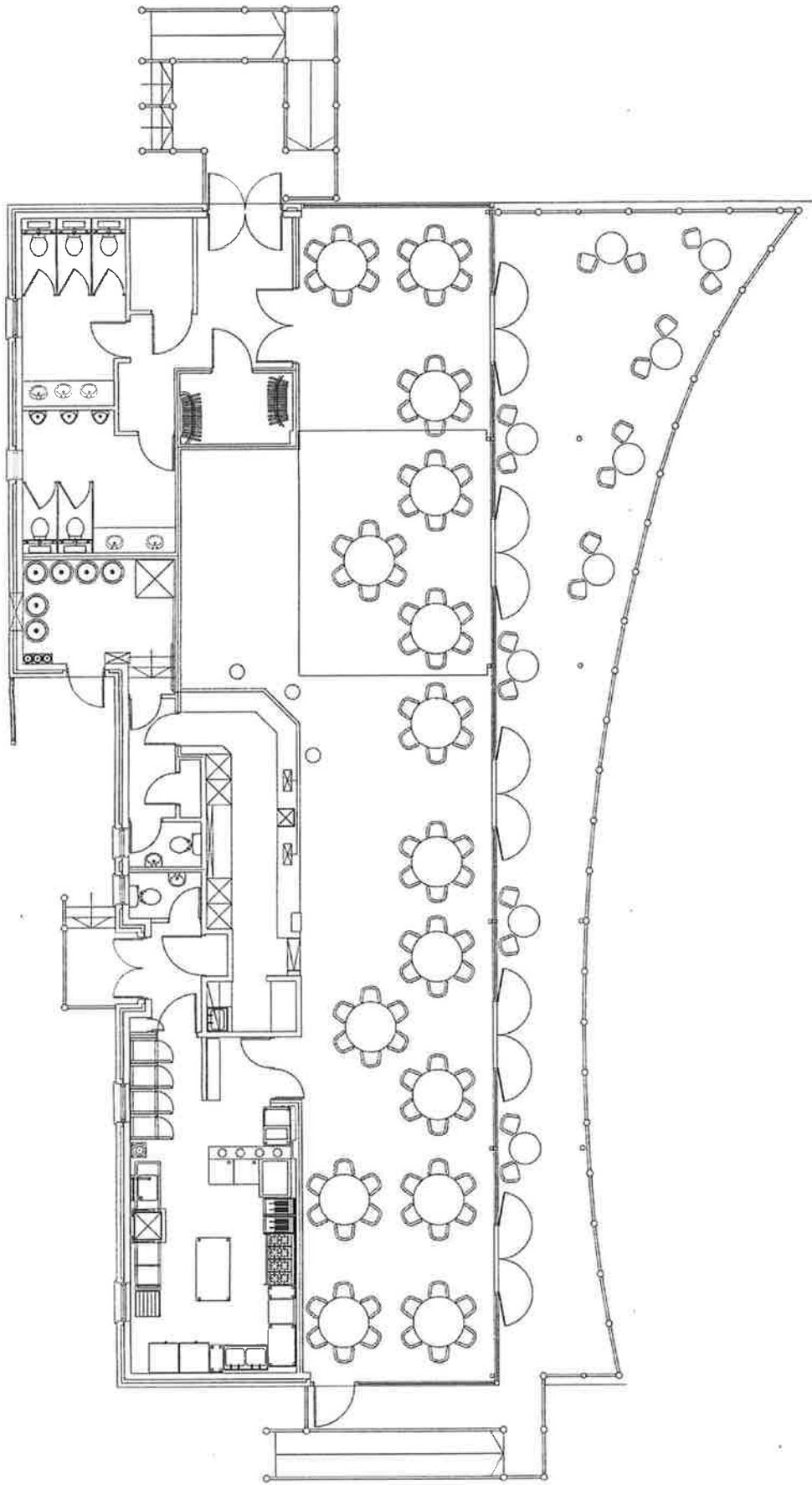

PIERCE HILL PROJECT SERVICES  
Hospitality Suite (Ground) Level  
Romford Stadium Romford

P04-142:05 1:100



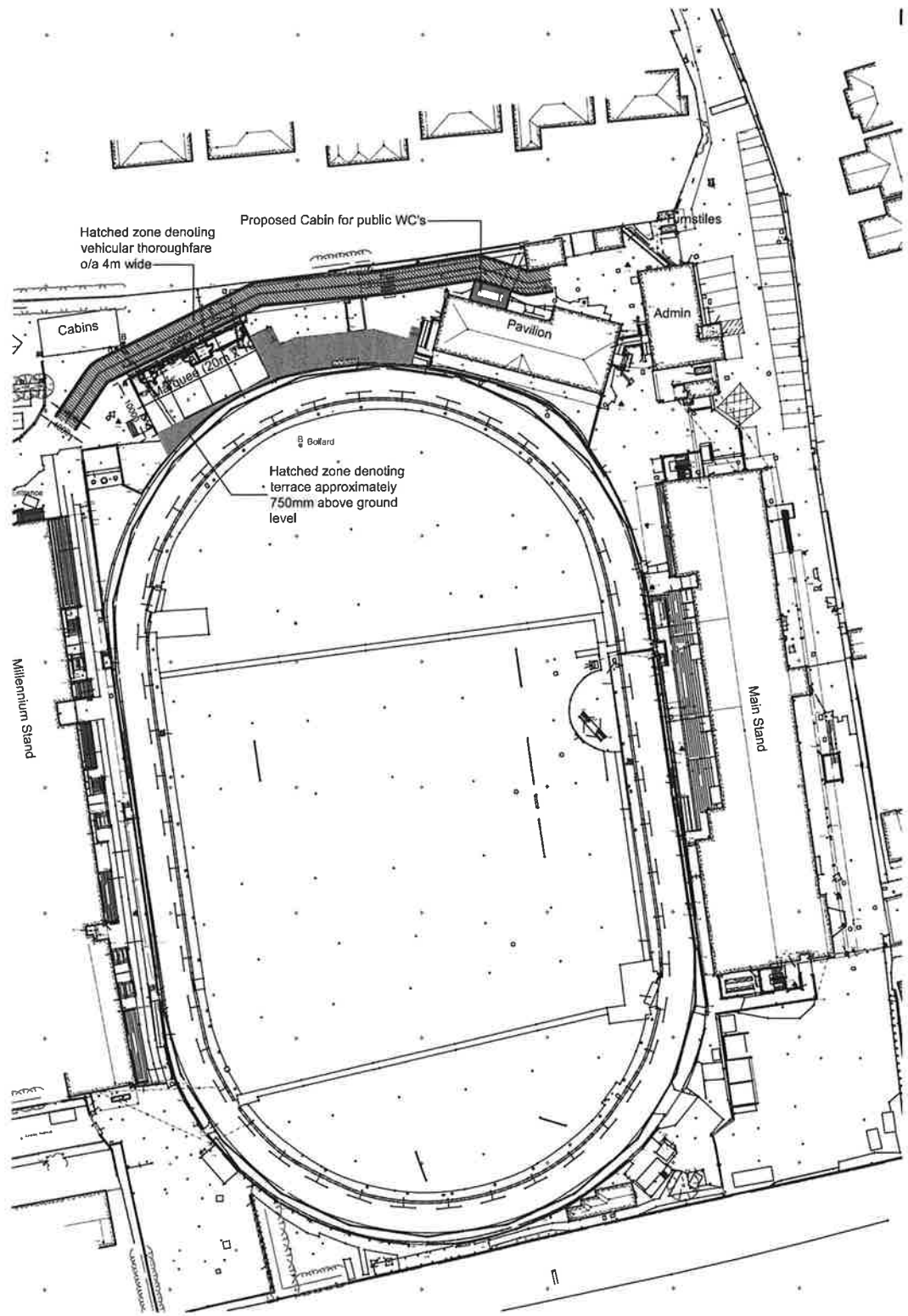

Hatched zone denoting vehicular thoroughfare o/a 4m wide

Proposed Cabin for public WC's

Cabins

Pavilion

Admin

Turnstiles

Bollard

Hatched zone denoting terrace approximately 750mm above ground level

Millennium Stand

Main Stand